

This order is being re-recorded  
to correct a clerical error in the  
Notary Clause.

260000391  
250000474

INSTRUMENT PREPARED BY  
VIRGINIA GAS AND OIL BOARD

ORDER RECORDED UNDER CODE  
OF VIRGINIA SECTION 45.2-1628

V I R G I N I A:

BEFORE THE VIRGINIA GAS AND OIL BOARD

APPLICANT: **Pocahontas Gas LLC** ) VIRGINIA GAS  
) AND OIL BOARD  
RELIEF SOUGHT: (1) MODIFICATION OF UNIT ACREAGE; )  
(2) DISMISSAL OF RESPONDENTS; AND )  
(3) MODIFICATION OF DIVISION OF )  
INTERESTS. ) DOCKET NO.  
) **VGOB-23-1121-4277-01**  
)  
LEGAL DESCRIPTION: )  
)  
BUCHANAN No.1 VS-18 )  
KEEN MOUNTAIN/JEWELL RIDGE/HONAKER )  
QUADRANGLE (S) , )  
GARDEN/MAIDEN SPRING/NEW GARDEN )  
MAGISTERIAL DISTRICT(S) )  
BUCHANAN/TAZEWELL/RUSSELL COUNTY(S) ,VIRGINIA )

REPORT OF THE BOARD

FINDINGS AND ORDER

1. Hearing Date and Place: This matter came for hearing before the Virginia Gas and Oil board (hereafter "Board") at 10:00 a.m. on **April 15, 2025** at Virginia Energy 3405 Mountain Empire Road, Big Stone Gap, Virginia and was approved.

2. Appearances: **Mark Swartz, Esq.**, appeared for the Applicant. Jessica Cooper of the Office of Attorney General was present to advise the Board.

3. Jurisdiction and Notice: Pursuant to Va. Code §§45.2-1600 et seq., the Board finds that it has jurisdiction over the subject matter. The Board further finds that the Applicant has met the requirements of 4VAC25-160-140, to-wit: (1) it has provided the names and addresses of all Respondents; (2) it has mailed a copy of the Miscellaneous Petition and Exhibits thereto to all Respondents for whom it has addresses; (3) it has provided and filed its proof of mailing; (4) it has published its Notice of Hearing and provided and filed Proof of Publication; and (5) its Petition identifies the issues and sets forth the specific relief requested.

4. Amendments: **none**

5. Dismissals: **none**

6. Relief Requested:

6.1 Applicant requests that the Board extract the acreage within the Buchanan No. 1 South 1 Panel SGU consisting of **298.43 acres**, from the Buchanan No. 1 VS-18 Unit. The boundaries of the acreage to be extracted are depicted in Exhibit A hereto which unit and acreage are bounded as follows:

Beginning at a point, Virginia State Plane NAD 83 coordinate of N:  
3593834.13 E: 10485609.83 (southwest corner of Buchanan Mine #1 South 1

260000391  
250000474

Panel Sealed Gob Unit); thence S 89°43'34" E 1413.36 feet to a point, Virginia State Plane NAD 83 coordinate of N: 3593827.37 E: 10487023.18 (southeast corner of Buchanan Mine #1 Sealed Gob Unit South 1 Panel); thence N 43°58'55" W 93.33 feet to a point, Virginia State Plane NAD 83 coordinate of N: 3593894.52 E: 10486958.37; thence N: 01°38'34" E 9743.31 feet to a point, Virginia State Plane NAD 83 coordinate of N: 3603633.83 E: 10487237.70 (northeast corner of Buchanan Mine #1 Sealed Gob Unit South 1 Panel); thence N 39°28'40" W 229.37 feet to a point, Virginia State Plane NAD 83 coordinate of N: 3603456.78 E: 10487091.87; thence N 88°23'00" W 1206.00 feet a point of beginning, containing +/- **298.43** acres.

6.2 That the Board re-establish the percentages for division of interest for production, revenue, and costs for all Respondents with acreage remaining in the Buchanan No. 1 VS-18 Unit in accordance with those percentages set forth in Revised Exhibit B to the Application.

7. Relief Granted: The requested relief in this cause shall be and hereby is granted and:

7.1 The relief requested and granted is just and reasonable, is supported by substantial evidence and will afford each person listed and named in **Revised Exhibit B** hereto the opportunity to recover or receive, without unnecessary expense, such person's just and fair share of the production from the Subject Unit. The granting of the Application and relief requested therein will ensure to the extent possible the greatest ultimate recovery of Coalbed Methane Gas, prevent or assist in preventing the various types of waste prohibited by statute and protect or assist in protecting the correlative rights of all persons in the subject common sources of supply in the Subject Lands. Therefore, the Board is entering an Order granting the relief herein set forth.

8. Mailing Of Order And Filing Of Affidavit: Applicant or its Attorney shall file an affidavit with the Secretary of the Board within sixty (60) days after the date of recording of this Order stating that a true and correct copy of said Order was mailed within seven (7) days from the date of its receipt by Unit Operator to each Respondent named in **Revised Exhibit B** included with this Order and whose address is known.

9. Availability of Unit Records: The Director shall provide all persons not subject to a lease with reasonable access to all records for Subject Unit which are submitted by the Unit Operator to said Director and/or his Inspector(s).

10. Conclusion: Therefore, the requested relief and all terms and provisions set forth above be and hereby are granted and IT IS SO ORDERED.

11. Appeals: Appeals of this Order are governed by the provisions of Va. Code Ann. § 45.2-1625 which provides that any order or decision of the Board may be appealed to the appropriate circuit court.

12. Effective Date: This Order shall be effective as of the date of the Board's approval of this Application, which is set forth at Paragraph 1 above.

Corrected Page

260000391

250000474

DONE AND EXECUTED this 21 day of April, 2025 by a majority of the Virginia Gas and Oil Board.

*Gus W. Janson*

Interim Chairman, Gus W. Janson

DONE AND PERFORMED this 21 day of April, 2025 by Order of the Virginia Gas and Oil Board.

*James P. Skorupa*

James P. Skorupa  
Principal Executive to the staff,  
Virginia Gas and Oil Board

COMMONWEALTH OF VIRGINIA  
COUNTY OF RUSSELL

Acknowledged on this 21<sup>st</sup> day of April, 2025, personally before me a notary public in and for the Commonwealth of Virginia, appeared Donald L. Rattiff, being duly sworn did depose and say that he is the Interim Chairman of the Virginia Gas and Oil Board and appeared James P. Skorupa, being duly sworn did depose and say that he is Principal Executive to the staff of the Virginia Gas and Oil Board, that they executed the same and was authorized to do so. *Gus W. Janson 3-12-26 JJJ*

*Sarah Jessee Gilmer*  
Sarah Jessee Gilmer, Notary Public  
262946

My Commission expires: July 31, 2025

*Sarah Jessee Gilmer* 3-12-26



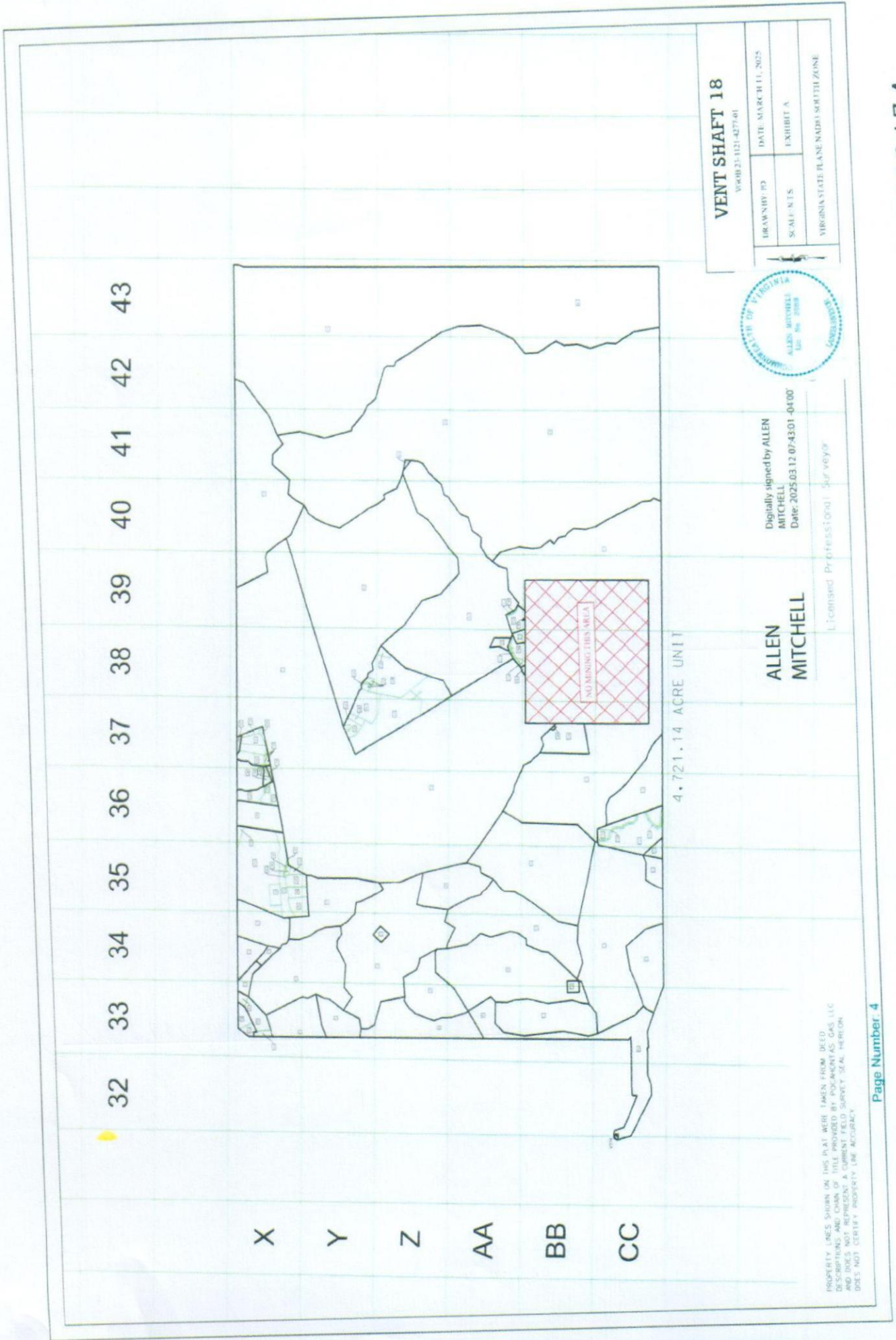

250000474

260000391

250000474

**Pocahontas Gas LLC  
VS18 (4,721.14 acre unit)  
Tract Identifications**

- 1A. Coal Mountain Mining Company, LLP (67.00 Acre Tract) – Coal  
Buchanan Mining Company LLC – Below Drainage Coal Leased  
RAMACO Resources Land Holdings, LLC – Coal In Tiller and Above Leased  
Patricia Cook, et al – Surface, Oil, and Gas  
Pocahontas Gas LLC – Oil, Gas and CBM Leased  
1.75 Acres                      0.3022%
- 1B. Coal Mountain Mining Company, LLP (67.00 Acre Tract) – Coal  
Buchanan Mining Company LLC – Below Drainage Coal Leased  
RAMACO Resources Land Holdings, LLC – Coal In Tiller and Above Leased  
Pocahontas Gas LLC – Oil, Gas and CBM  
3.59 Acres                      0.0715%
2.     **Transferred to Buch No 1 South 1 Panel SGU**
3.     **Transferred to Buch No 1 South 1 Panel SGU**
- 4A. Coal Mountain Mining Company, LLP (31.00 Acre Tract) – Coal and Gas  
Buchanan Mining Company LLC – Below Drainage Coal Leased  
RAMACO Resources Land Holdings, LLC – Coal In Tiller and Above Leased  
Gary Davis, et al – Minerals less Coal and Gas  
1.32 Acres                      0.1795%
- 4B. Coal Mountain Mining Company, LLP (31.00 Acre Tract) – Coal and Gas  
Buchanan Mining Company LLC – Below Drainage Coal Leased  
RAMACO Resources Land Holdings, LLC – Coal In Tiller and Above Leased  
Pocahontas Gas LLC – CBM Leased  
Elbert Boyd Heirs – Minerals less Coal and Gas  
6.70 Acres                      0.1335%
- 4C. Coal Mountain Mining Company, LLP (31.00 Acre Tract) – Coal  
Buchanan Mining Company LLC – Below Drainage Coal Leased  
RAMACO Resources Land Holdings, LLC – Coal In Tiller and Above Leased  
Pocahontas Gas LLC – Oil, Gas and CBM  
1.57 Acres                      0.0313%
5. Coal Mountain Mining Company, LLP (94.00 Acre Tract) – Coal  
Buchanan Mining Company LLC – Below Drainage Coal Leased  
RAMACO Resources Land Holdings, LLC – Coal In Tiller and Above Leased  
Pocahontas Gas LLC – Oil, Gas and CBM  
26.20 Acres                      0.9143%
6.     **Transferred to Buch No 1 South 1 Panel SGU**

"This title block is for general informational purposes only and does not reflect an analysis of the severance deed and its effect upon coal bed methane ownership and should not be relied upon for such purpose."

260000391

**Pocahontas Gas LLC  
VS18 (4,721.14 acre unit)  
Tract Identifications**

250000474

7. Coal Mountain Mining Company, LLP (94.00 Acre Tract) – Coal  
Buchanan Mining Company LLC – Below Drainage Coal Leased  
RAMACO Resources Land Holdings, LLC – Coal in Tiller and Above Leased  
Allie Davis Clowers, et al – Oil and Gas  
17.47 Acres 0.8248%
8. Coal Mountain Mining Company, LLP (331.00 Acre Tract) – All Minerals  
Buchanan Mining Company LLC – Below Drainage Coal Leased  
RAMACO Resources Land Holdings, LLC – Coal in Tiller and Above Leased  
Pocahontas Gas LLC – Oil, Gas, and CBM Leased  
41.68 Acres 3.0488%
9. **Transferred to Buch No 1 South 1 Panel SGU**
10. Coal Mountain Mining Company, LLP (346.00 Acres Tract 290) - Minerals  
Buchanan Mining Company LLC – Below Drainage Coal Leased  
RAMACO Resources Land Holdings, LLC – Coal in the Tiller and Above Leased  
Pocahontas Gas LLC – Oil, Gas, and CBM Leased  
56.40 Acres 3.1267%
11. Coal Mountain Mining Company, L.L.P. (35.00 Acres Tract 30) – All Minerals  
Buchanan Mining Company LLC – Below Drainage Coal Leased  
RAMACO Resources Land Holdings, LLC – Coal in Tiller and Above Leased  
Pocahontas Gas LLC – Oil, Gas, and CBM Leased  
46.79 Acres 0.9322%
12. Buchanan Mining Company, LLC – Coal  
Pocahontas Gas LLC – Oil, Gas, and CBM  
5.17 Acres 0.1030%
13. Coal Mountain Mining Company, L.L.P. (79.00 Acres) – All Minerals  
Buchanan Mining Company LLC – Below Drainage Coal Leased  
RAMACO Resources Land Holdings, LLC – Coal in Tiller and Above Leased  
Pocahontas Gas LLC – Oil, Gas, and CBM Leased  
86.43 Acres 1.7219%
14. Buchanan Mining Company LLC, et al – Coal  
Island Creek Coal Company – Coal Below Tiller Seam Leased  
Buchanan Mining Company LLC, et al – P3 Seam Leased  
Mountaineer Metallurgical Holdings LLC – Tiller and Above Coal Leased  
Weyerhaeuser NR Company, et al – Oil, Gas, and CBM  
Pocahontas Gas LLC – CBM Leased  
11.23 Acres 0.2237%

"This title block is for general informational purposes only and does not reflect an analysis of the severance deed and its effect upon coal bed methane ownership and should not be relied upon for such purpose."

**Pocahontas Gas LLC  
VS18 (4,721.14 acre unit)  
Tract Identifications**

15. Commonwealth of Virginia – All minerals except P-3 Seam  
Buchanan Mining Company LLC – Coal in P-3 Seam  
Pocahontas Gas LLC – Oil and Gas in P-3 Seam  
3.01 Acres      0.0600%
  
16. Coal Mountain Mining Company, L.L.P. (182.00 Acres) – All Minerals  
Buchanan Mining Company LLC – Below Drainage Coal Leased  
RAMACO Resources Land Holdings, LLC – Coal in Tiller and Above Leased  
Pocahontas Gas LLC – Oil, Gas, and CBM Leased  
152.88 Acres    3.0456%
  
17. Buchanan Mining Company LLC – Coal  
Pocahontas Gas LLC – Oil, Gas, and CBM  
2.00 Acres      0.0398%
  
18. Coal Mountain Mining Company, L.L.P. (35.00 Acres Tract 8) – Fee  
Buchanan Mining Company LLC – Below Drainage Coal Leased  
RAMACO Resources Land Holdings, LLC – Coal in Tiller and Above Leased  
Pocahontas Gas LLC – Oil, Gas, and CBM Leased  
38.14 Acres    0.7599%
  
19. Coal Mountain Mining Company, L.L.P. (182.00 Acres) – All Minerals  
Buchanan Mining Company LLC – Below Drainage Coal Leased  
RAMACO Resources Land Holdings, LLC – Coal in Tiller and Above Leased  
Pocahontas Gas LLC – Oil, Gas, and CBM Leased  
115.45 Acres    2.3001%
  
20. Thomas P. Stilwell – Fee  
2.07 Acres      0.0412%
  
21. Coal Mountain Mining Company, L.L.P. (160.00 Acres Tract 34) – All Minerals  
Buchanan Mining Company LLC – Below Drainage Coal Leased  
RAMACO Resources Land Holdings, LLC – Coal in Tiller and Above Leased  
Pocahontas Gas LLC – Oil, Gas, and CBM Leased  
162.41 Acres    3.2355%
  
22. Coal Mountain Mining Company, L.L.P. (181.00 Acres Tract 35) – All Minerals  
Buchanan Mining Company LLC – Below Drainage Coal Leased  
RAMACO Resources Land Holdings, LLC – Coal in Tiller and Above Leased  
Pocahontas Gas LLC – Oil, Gas, and CBM Leased  
35.17 Acres    0.7007%

"This title block is for general informational purposes only and does not reflect an analysis of the severance deed and its effect upon coal bed methane ownership and should not be relied upon for such purpose."

260000391

250000474

**Pocahontas Gas LLC  
VS18 (4,721.14 acre unit)  
Tract Identifications**

23. Coal Mountain Mining Company, L.L.P. (177.00 Acres Tract 36) – Coal  
Buchanan Mining Company LLC – Below Drainage Coal Leased  
RAMACO Resources Land Holdings, LLC – Coal in Tiller and Above Leased  
Pocahontas Gas LLC, et al (GW McGlothlin 47.90)– Oil and Gas (98.5119% Owned)  
7.12 Acres      0.1419%
24. Coal Mountain Mining Company, L.L.P. (102.00 Acres Tract 32) – All Minerals  
Buchanan Mining Company LLC – Below Drainage Coal Leased  
RAMACO Resources Land Holdings, LLC – Coal in Tiller and Above Leased  
Pocahontas Gas LLC – Oil, Gas, and CBM Leased  
91.31 Acres      1.8191%
25. Coal Mountain Mining Company, L.L.P. (122.00 Acres Tract 33) – All Minerals  
Buchanan Mining Company LLC – Below Drainage Coal Leased  
RAMACO Resources Land Holdings, LLC – Coal in Tiller and Above Leased  
Pocahontas Gas LLC – Oil, Gas, and CBM Leased  
134.88 Acres      2.6870%
26. Coal Mountain Mining Company, L.L.P. (44.75 Acres Tract 11) – Coal  
Buchanan Mining Company LLC – Below Drainage Coal Leased  
RAMACO Resources Land Holdings, LLC – Coal in Tiller and Above Leased  
Connie L. Davidson – Oil, Gas and CBM  
Pocahontas Gas LLC – Oil, Gas, and CBM Leased  
39.28 Acres      0.7826%
27. Coal Mountain Mining Company, L.L.P. (53.00 Acres Tract 33) – All Minerals  
Buchanan Mining Company LLC – Below Drainage Coal Leased  
RAMACO Resources Land Holdings, LLC – Coal in Tiller and Above Leased  
Pocahontas Gas LLC – Oil, Gas, and CBM Leased  
52.15 Acres      1.0390%
28. Buchanan Mining Company LLC, et al – Coal  
Island Creek Coal Company – Coal Below Tiller Seam Leased  
Buchanan Mining Company LLC, et al – P3 Seam Leased  
Revelation Energy, LLC – Tiller and Above Coal Leased  
Weyerhaeuser NR Company, et al – Oil, Gas and CBM  
Pocahontas Gas LLC – CBM Leased  
27.30 Acres      0.5439%
- 29A. Hurt-McGuire Heirs Trust (628.44 Acre Tract) – Coal  
Buchanan Mining Company LLC – Below Drainage Coal Leased  
RAMACO Resources Land Holdings, LLC – Coal in Tiller and Above Leased  
Janice Davis, et vir – Surface, Oil and Gas  
5.59 Acres      0.1114%

"This title block is for general informational purposes only and does not reflect an analysis of the severance deed and its effect upon coal bed methane ownership and should not be relied upon for such purpose."

260000391

**Pocahontas Gas LLC  
VS18 (4,721.14 acre unit)  
Tract Identifications**

250000474

- 29B. Hurt-McGuire Heirs Trust (628.44 Acre Tract) – Coal  
Buchanan Mining Company LLC – Below Drainage Coal Leased  
RAMACO Resources Land Holdings, LLC – Coal in Tiller and Above Leased  
William L. Engardio – Surface, Oil and Gas  
3.74 Acres      0.0745%
- 29C. Hurt-McGuire Heirs Trust (628.44 Acre Tract) – Coal  
Buchanan Mining Company LLC – Below Drainage Coal Leased  
RAMACO Resources Land Holdings, LLC – Coal in Tiller and Above Leased  
Pocahontas Gas LLC – Surface, Oil and Gas  
3.80 Acres      0.0757%
- 29D. Hurt-McGuire Heirs Trust (628.44 Acre Tract) – Coal  
Buchanan Mining Company LLC – Below Drainage Coal Leased  
RAMACO Resources Land Holdings, LLC – Coal in Tiller and Above Leased  
Danny Wayne Hinkle – Surface, Oil and Gas  
1.24 Acres      0.0247%
- 29E. Hurt-McGuire Heirs Trust (628.44 Acre Tract) – Coal  
Buchanan Mining Company LLC – Below Drainage Coal Leased  
RAMACO Resources Land Holdings, LLC – Coal in Tiller and Above Leased  
Commonwealth of Virginia (US 460) – Surface, Oil and Gas  
9.87 Acres      0.1966%
- 29F. Hurt-McGuire Heirs Trust (628.44 Acre Tract) – Coal  
Buchanan Mining Company LLC – Below Drainage Coal Leased  
RAMACO Resources Land Holdings, LLC – Coal in Tiller and Above Leased  
Russell V. Presley, et ux – Surface, Oil and Gas  
3.97 Acres      0.0791%
- 29G. Hurt-McGuire Heirs Trust (628.44 Acre Tract) – Coal  
Buchanan Mining Company LLC – Below Drainage Coal Leased  
RAMACO Resources Land Holdings, LLC – Coal in Tiller and Above Leased  
JADCO Inc. – Surface, Oil and Gas  
0.08 Acres      0.0016%
- 29H. Hurt-McGuire Heirs Trust (628.44 Acre Tract) – Coal  
Buchanan Mining Company LLC – Below Drainage Coal Leased  
RAMACO Resources Land Holdings, LLC – Coal in Tiller and Above Leased  
JADCO Inc. – Surface, Oil and Gas  
0.61 Acres      0.0122%

"This title block is for general informational purposes only and does not reflect an analysis of the severance deed and its effect upon coal bed methane ownership and should not be relied upon for such purpose."

260000391

**Pocahontas Gas LLC  
VS18 (4,721.14 acre unit)  
Tract Identifications**

250000474

- 29I. Hurt-McGuire Heirs Trust (628.44 Acre Tract) – Coal  
Buchanan Mining Company LLC – Below Drainage Coal Leased  
RAMACO Resources Land Holdings, LLC – Coal in Tiller and Above Leased  
JADCO Inc. – Surface, Oil and Gas  
0.23 Acres 0.0046%
- 29J. Hurt-McGuire Heirs Trust (628.44 Acre Tract) – Coal  
Buchanan Mining Company LLC – Below Drainage Coal Leased  
RAMACO Resources Land Holdings, LLC – Coal in Tiller and Above Leased  
Pocahontas Gas LLC – Oil and Gas  
0.02 Acres 0.0004%
- 29K. Hurt-McGuire Heirs Trust (628.44 Acre Tract) – Coal  
Buchanan Mining Company LLC – Below Drainage Coal Leased  
RAMACO Resources Land Holdings, LLC – Coal in Tiller and Above Leased  
Pocahontas Gas LLC – Oil, Gas and CBM  
47.18 Acres 0.9400%
- 29L. Hurt-McGuire Heirs Trust (628.44 Acre Tract) – Coal  
Buchanan Mining Company LLC – Below Drainage Coal Leased  
RAMACO Resources Land Holdings, LLC – Coal in Tiller and Above Leased  
Joel and Brenda Burke – Surface, Oil and Gas  
1.16 Acres 0.0231%
- 29M. Hurt-McGuire Heirs Trust (628.44 Acre Tract) – Coal  
Buchanan Mining Company LLC – Below Drainage Coal Leased  
RAMACO Resources Land Holdings, LLC – Coal in Tiller and Above Leased  
Pocahontas Gas LLC – Oil, Gas and CBM  
4.54 Acres 0.0904%
- 29N. Hurt-McGuire Heirs Trust (628.44 Acre Tract) – Coal  
Buchanan Mining Company LLC – Below Drainage Coal Leased  
RAMACO Resources Land Holdings, LLC – Coal in Tiller and Above Leased  
Pocahontas Gas LLC – Surface, Oil and Gas  
2.33 Acres 0.0464%
- 29O. Hurt-McGuire Heirs Trust (628.44 Acre Tract) – Coal  
Buchanan Mining Company LLC – Below Drainage Coal Leased  
RAMACO Resources Land Holdings, LLC – Coal in Tiller and Above Leased  
Commonwealth of Virginia (US 460) – Oil and Gas  
1.98 Acres 0.0394%

"This title block is for general informational purposes only and does not reflect an analysis of the severance deed and its effect upon coal bed methane ownership and should not be relied upon for such purpose."

**Pocahontas Gas LLC  
VS18 (4,721.14 acre unit)  
Tract Identifications**

250000474

- 29P. Hurt-McGuire Heirs Trust (628.44 Acre Tract) – Coal  
Buchanan Mining Company LLC – Below Drainage Coal Leased  
RAMACO Resources Land Holdings, LLC – Coal in Tiller and Above Leased  
Pocahontas Gas LLC – Oil, Gas and CBM  
10.54 Acres    0.2100%
- 29Q. Hurt-McGuire Heirs Trust (628.44 Acre Tract) – Coal  
Buchanan Mining Company LLC – Coal Below Tiller Seam Leased  
RAMACO Resources Land Holdings, LLC – Coal in Tiller and Above Leased  
Pocahontas Gas LLC – Oil and Gas  
1.21 Acres    0.0241%
- 29R. Hurt-McGuire Heirs Trust (628.44 Acre Tract) – Coal  
Buchanan Mining Company LLC – Coal Below Tiller Seam Leased  
RAMACO Resources Land Holdings, LLC – Coal in Tiller and Above Leased  
Commonwealth of Virginia (SR 727) – Oil and Gas  
0.50 Acres    0.0100%
- 29S. Hurt-McGuire Land Trust (628.44 Acre Tract) – Coal  
Buchanan Mining Company LLC – Coal Below Tiller Seam Leased  
RAMACO Resources Land Holdings, LLC – Coal in Tiller and Above Leased  
Commonwealth of Virginia (SR 727) – Oil and Gas  
0.68 Acres    0.0135%
- 29T. Hurt-McGuire Heirs Trust (628.44 Acre Tract) – Coal  
Buchanan Mining Company LLC – Coal Below Tiller Seam Leased  
RAMACO Resources Land Holdings, LLC – Coal in Tiller and Above Leased  
Donald Ray Young – Oil and Gas  
7.31 Acres    0.1456%
- 29U. Hurt-McGuire Heirs Trust (628.44 Acre Tract) – Coal  
Buchanan Mining Company LLC – Coal Below Tiller Seam Leased  
RAMACO Resources Land Holdings, LLC – Coal in Tiller and Above Leased  
Patrick Counts – Oil and Gas  
3.39 Acres    0.0675%
- 29V. Hurt-McGuire Heirs Trust (628.44 Acre Tract) – Coal  
Buchanan Mining Company LLC – Coal Below Tiller Seam Leased  
RAMACO Resources Land Holdings, LLC – Coal in Tiller and Above Leased  
Pocahontas Gas LLC – Oil and Gas  
1.49 Acres    0.0297%

"This title block is for general informational purposes only and does not reflect an analysis of the severance deed and its effect upon coal bed methane ownership and should not be relied upon for such purpose."

260000391

**Pocahontas Gas LLC  
VS18 (4,721.14 acre unit)  
Tract Identifications**

250000474

- 29W. Hurt-McGuire Heirs Trust (628.44 Acre Tract) – Coal  
Buchanan Mining Company LLC – Coal Below Tiller Seam Leased  
RAMACO Resources Land Holdings, LLC – Coal in Tiller and Above Leased  
Grady McGlothlin, et ux – Oil and Gas  
0.90 Acres 0.0179%
- 29X. Hurt-McGuire Heirs Trust (628.44 Acre Tract) – Coal  
Buchanan Mining Company LLC – Coal Below Tiller Seam Leased  
RAMACO Resources Land Holdings, LLC – Coal in Tiller and Above Leased  
Commonwealth of Virginia (SR 727) – Oil and Gas  
1.10 Acres 0.0219%
- 29Y. Hurt-McGuire Heirs Trust (628.44 Acre Tract) – Coal  
Buchanan Mining Company LLC – Coal Below Tiller Seam Leased  
RAMACO Resources Land Holdings, LLC – Coal in Tiller and Above Leased  
Oris Ellis Cantrell Heirs – Oil and Gas  
0.89 Acres 0.0177%
30. Buchanan Mining Company LLC, et al (Big Vein Tract) – All Minerals  
Island Creek Coal Company – Coal Below Tiller Seam Leased  
Buchanan Mining Company LLC – P3 Seam of Coal Sub-Leased  
Revelation Energy, LLC – Tiller and Above Coal Leased  
Weyerhaeuser NR Company, et al – Oil, Gas and CBM  
Pocahontas Gas LLC – CBM Leased  
16.35 Acres 0.3257%
31. Commonwealth Coal Corporation (965.00 Acre Tract 2) – All Minerals  
Buchanan Mining Company LLC – Below Drainage Coal Leased  
RAMACO Resources Land Holdings, LLC – Coal in Tiller and Above Leased  
Pocahontas Gas LLC – Oil, Gas and CBM Leased  
779.46 Acres 15.5282%
32. Coal Mountain Mining Company, L.L.P. (319.00 Acre Tract 56) – All Minerals  
Buchanan Mining Company LLC – Below Drainage Coal Leased  
RAMACO Resources Land Holdings, LLC – Above Drainage Coal Leased  
Pocahontas Gas LLC – Oil, Gas, and CBM Leased  
Map 63A Parcel 5  
3.14 Acres 0.0626%

"This title block is for general informational purposes only and does not reflect an analysis of the severance deed and its effect upon coal bed methane ownership and should not be relied upon for such purpose."

**Pocahontas Gas LLC  
VS18 (4,721.14 acre unit)  
Tract Identifications**

- 33A. Coal Mountain Mining Company, L.L.P. (40.00 Acre Tract 37) – Coal  
Buchanan Mining Company LLC – Below Drainage Coal Leased  
RAMACO Resources Land Holdings, LLC – Above Drainage Coal Leased  
Granville McGlothlin Heirs, et al – Oil and Gas (98.5119% Owned)  
Pocahontas Gas LLC – CBM Leased  
Map 63A Parcel 3  
26.89 Acres    0.5357%
- 33B. Coal Mountain Mining Company, L.L.P. (40.00 Acre Tract 37) – Coal  
Buchanan Mining Company LLC – Below Drainage Coal Leased  
RAMACO Resources Land Holdings, LLC – Above Drainage Coal Leased  
Commonwealth of Virginia – Oil and Gas  
Map 63A Parcel 0  
2.31 Acres    0.0460%
- 33C. Coal Mountain Mining Company, L.L.P. (40.00 Acre Tract 37) – Coal  
Buchanan Mining Company LLC – Below Drainage Coal Leased  
RAMACO Resources Land Holdings, LLC – Above Drainage Coal Leased  
Jimmy Lee McGlothlin – Oil and Gas  
Map 63A Parcel 2  
1.62 Acres    0.0323%
34. Coal Mountain Mining Company, L.L.P. (319.00 Acre Tract 38) – All Minerals  
Buchanan Mining Company LLC – Below Drainage Coal Leased  
RAMACO Resources Land Holdings, LLC – Above Drainage Coal Leased  
Pocahontas Gas LLC – Oil, Gas, and CBM Leased  
Map 34A Parcel 37  
36.48 Acres    0.7268%
35. Commonwealth Coal Corporation (May & Painter Tract 1497.62 Acre Tract) – Fee  
Buchanan Mining Company LLC – Below Drainage Coal Leased  
RAMACO Resources Land Holdings, LLC – Coal in Tiller and Above Leased  
Pocahontas Gas LLC – Oil, Gas and CBM Leased  
Map 84A Parcel 122A  
301.98 Acres    6.0161%
- 36A. Commonwealth Coal Corporation (67.45 Acre Tract 6) – Coal  
Buchanan Mining Company LLC – Below Drainage Coal Leased  
RAMACO Resources Land Holdings, LLC – Coal in Tiller and Above Leased  
Bernard Shortt, et al – Oil and Gas  
Map 64A Parcel 35  
19.31 Acres    0.3847%

"This title block is for general informational purposes only and does not reflect an analysis of the severance deed and its effect upon coal bed methane ownership and should not be relied upon for such purpose."

**Pocahontas Gas LLC  
VS18 (4,721.14 acre unit)  
Tract Identifications**

250000474

- 36B. Commonwealth Coal Corporation (67.45 Acre Tract 6) – Coal  
Buchanan Mining Company LLC – Below Drainage Coal Leased  
RAMACO Resources Land Holdings, LLC – Coal in Tiller and Above Leased  
Bernard Shortt, et al – Oil and Gas  
Map 64A Parcel 35A  
0.19 Acres      0.0038%
- 36C. Commonwealth Coal Corporation (67.45 Acre Tract 6) – Coal  
Buchanan Mining Company LLC – Below Drainage Coal Leased  
RAMACO Resources Land Holdings, LLC – Coal in Tiller and Above Leased  
Robert Rose, et ux or Tom Short Heirs – Oil and Gas  
Map 64A Parcel 34  
0.42 Acres      0.0084%
- 37A. Commonwealth Coal Corporation (29.23 Acre Tract 7) – Coal  
Buchanan Mining Company LLC – Below Drainage Coal Leased  
RAMACO Resources Land Holdings, LLC – Above Drainage Coal Leased  
Robert Rose, et ux or Tom Short Heirs – Oil and Gas  
0.76 Acres      0.0151%
- 37B. Commonwealth Coal Corporation (29.23 Acre Tract 7) – Coal  
Buchanan Mining Company LLC – Below Drainage Coal Leased  
RAMACO Resources Land Holdings, LLC – Above Drainage Coal Leased  
Walter Short, et al – Oil and Gas  
Map 64A Parcel 33  
8.89 Acres      0.1771%
- 37C. Commonwealth Coal Corporation (29.23 Acre Tract 7) – Coal  
Buchanan Mining Company LLC – Below Drainage Coal Leased  
RAMACO Resources Land Holdings, LLC – Above Drainage Coal Leased  
Commonwealth of VA – Oil and Gas  
Map 64A Parcel 0  
1.01 Acres      0.0201%
- 37D. Commonwealth Coal Corporation (29.23 Acre Tract 7) – Coal  
Buchanan Mining Company LLC – Below Drainage Coal Leased  
RAMACO Resources Land Holdings, LLC – Above Drainage Coal Leased  
Walter Short, et al – Oil and Gas  
Map 64A Parcel 32  
0.20 Acres      0.0040%

"This title block is for general informational purposes only and does not reflect an analysis of the severance deed and its effect upon coal bed methane ownership and should not be relied upon for such purpose."

260000391

250000474

**Pocahontas Gas LLC  
VS18 (4,721.14 acre unit)  
Tract Identifications**

- 37E. Commonwealth Coal Corporation (29.23 Acre Tract 7) – Coal  
Buchanan Mining Company LLC – Below Drainage Coal Leased  
RAMACO Resources Land Holdings, LLC – Coal in Tiller and Above Leased  
Walter Short, et al – All Minerals except Coal  
Map 64A Parcel 33A  
0.04 Acres      0.0008%
38. Commonwealth Coal Corporation (3.00 Acre Tract 6) – All Minerals  
Buchanan Mining Company LLC – Below Drainage Coal Leased  
RAMACO Resources Land Holdings, LLC – Coal in Tiller and Above Leased  
Pocahontas Gas LLC – Oil, Gas and CBM Leased  
Map 64A Parcel 33B  
2.04 Acres      0.0406%
39. Commonwealth Coal Corporation (2.25 Acre Tract 11) – All Minerals  
Buchanan Mining Company LLC – Below Drainage Coal Leased  
RAMACO Resources Land Holdings, LLC – Above Drainage Coal Leased  
Pocahontas Gas LLC – Oil, Gas and CBM Leased  
2.65 Acres      0.0528%
- 40A. Commonwealth Coal Corporation (T.D. Chambers 222.25 Acre Tract 5) – All Minerals except Oil  
Buchanan Mining Company LLC – Below Drainage Coal Leased  
RAMACO Resources Land Holdings, LLC – Above Drainage Coal Leased  
Pocahontas Gas LLC – Gas and CBM Leased  
212.51 Acres    4.2336%
- 40B. Commonwealth Coal Corporation (T.D. Chambers 222.25 Acre Tract 5) – All Minerals except Oil  
Buchanan Mining Company LLC – Below Drainage Coal Leased  
RAMACO Resources Land Holdings, LLC – Above Drainage Coal Leased  
Pocahontas Gas LLC – Gas and CBM Leased  
0.49 Acres      0.0098%
- 41A. Commonwealth Coal Corporation (87.13 Acre Tract 3) – Coal  
Buchanan Mining Company LLC – Below Drainage Coal Leased  
RAMACO Resources Land Holdings, LLC – Coal in Tiller and Above Leased  
Gary Addison, et al – Oil and Gas  
Pocahontas Gas LLC – Oil, Gas and CBM Leased  
43.66 Acres      0.8698%
- 41B. Commonwealth Coal Corporation (87.13 Acre Tract 3) – Coal  
Buchanan Mining Company LLC – Below Drainage Coal Leased  
RAMACO Resources Land Holdings, LLC – Coal in Tiller and Above Leased  
Curtis Wade Heirs – Oil and Gas  
23.97 Acres      0.4775%

"This title block is for general informational purposes only and does not reflect an analysis of the severance deed and its effect upon coal bed methane ownership and should not be relied upon for such purpose."

260000391

250000474

**Pocahontas Gas LLC**  
**VS18 (4,721.14 acre unit)**  
**Tract Identifications**

- 41C. Commonwealth Coal Corporation (87.13 Acre Tract 3) – Coal  
Buchanan Mining Company LLC – Below Drainage Coal Leased  
RAMACO Resources Land Holdings, LLC – Coal in Tiller and Above Leased  
Gerald K. Short – Oil and Gas  
10.72 Acres 0.2136%
- 41D. Commonwealth Coal Corporation (87.13 Acre Tract 3) – Coal  
Buchanan Mining Company LLC – Below Drainage Coal Leased  
RAMACO Resources Land Holdings, LLC – Coal in Tiller and Above Leased  
Rondal Wade, et al – Oil and Gas  
3.41 Acres 0.0679%
- 41E. Commonwealth Coal Corporation (87.13 Acre Tract 3) – Coal  
Buchanan Mining Company LLC – Below Drainage Coal Leased  
RAMACO Resources Land Holdings, LLC – Coal in Tiller and Above Leased  
Jimmy Wade, et ux – Oil and Gas  
1.72 Acres 0.0343%
- 41F. Commonwealth Coal Corporation (87.13 Acre Tract 3) – Coal  
Buchanan Mining Company LLC – Below Drainage Coal Leased  
RAMACO Resources Land Holdings, LLC – Coal in Tiller and Above Leased  
Evelyn Sprinkle Brown Heirs – Oil and Gas  
1.66 Acres 0.0331%
- 41G. Commonwealth Coal Corporation (87.13 Acre Tract 3) – Coal  
Buchanan Mining Company LLC – Below Drainage Coal Leased  
RAMACO Resources Land Holdings, LLC – Coal in Tiller and Above Leased  
Commonwealth of Virginia – Oil and Gas  
0.25 Acres 0.0050%
- 41H. Commonwealth Coal Corporation (87.13 Acre Tract 3) – Coal  
Buchanan Mining Company LLC – Below Drainage Coal Leased  
RAMACO Resources Land Holdings, LLC – Coal in Tiller and Above Leased  
Elmer Burke, et ux – Oil and Gas  
1.45 Acres 0.0289%
- 42. Commonwealth Coal Corporation (299.72 Acre Tract 4) – All Minerals  
Buchanan Mining Company LLC – Below Drainage Coal Leased  
RAMACO Resources Land Holdings, LLC – Coal in Tiller and Above Leased  
Pocahontas Gas LLC – Oil, Gas and CBM Leased  
301.84 Acres 6.0133%

"This title block is for general informational purposes only and does not reflect an analysis of the severance deed and its effect upon coal bed methane ownership and should not be relied upon for such purpose."

260000391

250000474

**Pocahontas Gas LLC  
VS18 (4,721.14 acre unit)  
Tract Identifications**

43. Coal Mountain Mining Company, L.L.P. (1140.00 Acre Tract 27) – All Minerals  
Buchanan Mining Company LLC – Below Drainage Coal Leased  
RAMACO Resources Land Holdings, LLC – Above Drainage Coal Leased  
Pocahontas Gas LLC – Oil, Gas and CBM Leased  
125.72 Acres 2.5047%
44. Commonwealth Coal Corporation (1027.00 Acre Tract 8) – All Minerals  
Buchanan Mining Company LLC – Below Drainage Coal Leased  
RAMACO Resources Land Holdings, LLC – Coal in Tiller and Above Leased  
Pocahontas Gas LLC – Oil, Gas and CBM Leased  
Map 64A Parcel 17  
882.64 Acres 17.5838%
45. Coal Mountain Mining Company, L.L.P. (1186.00 Acre Tract 39) – Fee  
Buchanan Mining Company LLC – Below Drainage Coal Leased  
RAMACO Resources Land Holdings, LLC – Coal in Tiller and Above Leased  
Pocahontas Gas LLC – Oil, Gas and CBM Leased  
Map 65A Parcel 10  
623.54 Acres 12.4221%

"This title block is for general informational purposes only and does not reflect an analysis of the severance deed and its effect upon coal bed methane ownership and should not be relied upon for such purpose."

BUCHANAN NO. 1  
SOUTH 1 PANEL SGU

VGOB 23-1121-4277

|                                      |                   |
|--------------------------------------|-------------------|
| DRAWN BY PD                          | DATE MARCH 7 2025 |
| SCALE N.T.S.                         | EXHIBIT A-4       |
| VIRGINIA STATE PLANE SACS/SOUTH ZONE |                   |



(AFFIX JOB#)

Licensed Professional Surveyor

VENT SHAFT 18  
VGOB 23-1121-4277



BUCHANAN NO. 1 SGU  
SOUTH 1 PANEL  
298.43 ACRE TRACT

VS18

250000474

260000391

Revised Exhibit B  
 VS18  
 Docket #VGOB 23-1121-4277-01  
 List of all Owners/Claimants  
 (4,721.14 Acre Unit)

250000474

|  | Acres in Unit | Interest in Unit |
|--|---------------|------------------|
| <b>I. COAL OWNERSHIP</b>   |               |                  |
| <u>Tract #1 - 5.34 acres</u>   |               |                  |
| (1) Coal Mountain Mining Company LLP<br>P.O. Box 675<br>Tazewell, VA 24651 | 5.34 acres    | 0.1131%          |
| <u>Tract #2 - Transferred to Buch No 1 South 1 Panel SGU</u>               |               |                  |
| <u>Tract #3 - Transferred to Buch No 1 South 1 Panel SGU</u>               |               |                  |
| <u>Tract #4 - 9.59 acres</u>   |               |                  |
| (1) Coal Mountain Mining Company LLP<br>P.O. Box 675<br>Tazewell, VA 24651 | 9.59 acres    | 0.2031%          |
| <u>Tract #5 - 26.20 Acres</u>  |               |                  |
| (1) Coal Mountain Mining Company LLP<br>P.O. Box 675<br>Tazewell, VA 24651 | 26.20 acres   | 0.5550%          |
| <u>Tract #6 - Transferred to Buch No 1 South 1 Panel SGU</u>               |               |                  |
| <u>Tract #7 - 17.47 Acres</u>  |               |                  |
| (1) Coal Mountain Mining Company LLP<br>P.O. Box 675<br>Tazewell, VA 24651 | 17.47 acres   | 0.3700%          |
| <u>Tract #8 - 41.68 Acres</u>  |               |                  |
| (1) Coal Mountain Mining Company LLP<br>P.O. Box 675<br>Tazewell, VA 24651 | 41.68 acres   | 0.8828%          |
| <u>Tract #9 - Transferred to Buch No 1 South 1 Panel SGU</u>               |               |                  |
| <u>Tract #10 - 56.40 Acres</u>   |               |                  |
| (1) Coal Mountain Mining Company LLP<br>P.O. Box 675<br>Tazewell, VA 24651 | 56.40 acres   | 1.1946%          |
| <u>Tract #11 - 46.79 Acres</u>   |               |                  |
| (1) Coal Mountain Mining Company LLP<br>P.O. Box 675<br>Tazewell, VA 24651 | 46.79 acres   | 0.9911%          |
| <u>Tract #12 - 5.17 Acres</u>  |               |                  |
| (1) Buchanan Mining Company LLC<br>PO Drawer L<br>Oakwood, VA 24631        | 5.17 acres    | 0.1095%          |
| <u>Tract #13 - 86.43 Acres</u>   |               |                  |
| (1) Coal Mountain Mining Company LLP<br>P.O. Box 675<br>Tazewell, VA 24651 | 86.43 acres   | 1.8307%          |

260000391

Revised Exhibit B  
 VS18  
 Docket #VGOB 23-1121-4277-01  
 List of all Owners/Claimants  
 (4,721.14 Acre Unit)

250000474

|   | Acres in Unit                       | Interest in Unit |
|---|-------------------------------------|------------------|
| <b><u>Tract #14 - 11.23 acres</u></b>   |                                     |                  |
| (1) Buchanan Mining Company LLC, et al  | 11.23 acres                         | 0.2379%          |
| (a) Yukon Pocahontas Coal Company<br>P.O. Box 187<br>Tazewell, VA 24651                           | 5.6150 acres<br>1/2 of 11.23 acres  | 0.1189%          |
| (b) Buchanan Coal Company<br>P.O. Box 187<br>Tazewell, VA 24651                                   | 1.2478 acres<br>1/9 of 11.23 acres  | 0.0264%          |
| (c) Sayers-Pocahontas Coal Company<br>P.O. Box 187<br>Tazewell, VA 24651                          | 0.6239 acres<br>1/18 of 11.23 acres | 0.0132%          |
| (d) Buchanan Mining Company LLC*<br>PO Drawer L<br>Oakwood, VA 24630                              | 3.7433 acres<br>1/3 of 11.23 acres  | 0.0793%          |
| <i>Note: Weyerhaeuser Company (previously Plum Creek Timberlands) retained their CBM interest</i> |                                     |                  |
| <b><u>Tract #15 - 3.01 Acres</u></b>  |                                     |                  |
| <i>Coal except P-3 Seam:</i>  |                                     |                  |
| (1) Commonwealth of Virginia<br>Department of Highways<br>2111 Bonham Road<br>Bristol, VA 24201   | 3.01 acres                          | 0.0638%          |
| <i>P-3 Seam of Coal:</i>  |                                     |                  |
| (2) Buchanan Mining Company LLC<br>PO Drawer L<br>Oakwood, VA 24630                               | 3.01 acres                          | 0.0638%          |
| <b><u>Tract #16 - 152.88 Acres</u></b>  |                                     |                  |
| (1) Coal Mountain Mining Company LLP<br>P.O. Box 675<br>Tazewell, VA 24651                        | 152.88 acres                        | 3.2382%          |
| <b><u>Tract #17 - 2.00 Acres</u></b>  |                                     |                  |
| (1) Buchanan Mining Company LLC<br>PO Drawer L<br>Oakwood, VA 24630                               | 2.00 acres                          | 0.0424%          |
| <b><u>Tract #18 - 38.14 Acres</u></b>   |                                     |                  |
| (1) Coal Mountain Mining Company LLP<br>P.O. Box 675<br>Tazewell, VA 24651                        | 38.14 acres                         | 0.8079%          |
| <b><u>Tract #19 - 115.45 Acres</u></b>  |                                     |                  |
| (1) Coal Mountain Mining Company LLP<br>P.O. Box 675<br>Tazewell, VA 24651                        | 115.45 acres                        | 2.4454%          |
| <b><u>Tract #20 - 2.07 Acres</u></b>  |                                     |                  |
| (1) Thomas P. Stilwell<br>1898 Old Kentucky Turnpike Road<br>Raven, VA 24639                      | 2.07 acres                          | 0.0438%          |

260000391

Revised Exhibit B  
 VS18  
 Docket #VGOB 23-1121-4277-01  
 List of all Owners/Claimants  
 (4,721.14 Acre Unit)

250000474

|  | Acres in Unit                       | Interest in Unit |
|--|-------------------------------------|------------------|
| <b><u>Tract #21 - 162.41 Acres</u></b>                                     |                                     |                  |
| (1) Coal Mountain Mining Company LLP<br>P.O. Box 675<br>Tazewell, VA 24651 | 162.41 acres                        | 3.4401%          |
| <b><u>Tract #22 - 35.17 Acres</u></b>                                      |                                     |                  |
| (1) Coal Mountain Mining Company LLP<br>P.O. Box 675<br>Tazewell, VA 24651 | 35.17 acres                         | 0.7449%          |
| <b><u>Tract #23 - 7.12 Acres</u></b>                                       |                                     |                  |
| (1) Coal Mountain Mining Company LLP<br>P.O. Box 675<br>Tazewell, VA 24651 | 7.12 acres                          | 0.1508%          |
| <b><u>Tract #24 - 91.31 Acres</u></b>                                      |                                     |                  |
| (1) Coal Mountain Mining Company LLP<br>P.O. Box 675<br>Tazewell, VA 24651 | 91.31 acres                         | 1.9341%          |
| <b><u>Tract #25 - 134.88 Acres</u></b>                                     |                                     |                  |
| (1) Coal Mountain Mining Company LLP<br>P.O. Box 675<br>Tazewell, VA 24651 | 134.88 acres                        | 2.8569%          |
| <b><u>Tract #26 - 39.28 Acres</u></b>                                      |                                     |                  |
| (1) Coal Mountain Mining Company LLP<br>P.O. Box 675<br>Tazewell, VA 24651 | 39.28 acres                         | 0.8320%          |
| <b><u>Tract #27 - 52.15 Acres</u></b>                                      |                                     |                  |
| (1) Coal Mountain Mining Company LLP<br>P.O. Box 675<br>Tazewell, VA 24651 | 52.15 acres                         | 1.1046%          |
| <b><u>Tract #28 - 27.30 Acres</u></b>                                      |                                     |                  |
| (1) Buchanan Mining Company LLC, et al                                     | 27.30 acres                         | 0.5783%          |
| (a) Yukon Pocahontas Coal Company<br>P.O. Box 187<br>Tazewell, VA 24651    | 13.6500 acres<br>1/2 of 27.30 acres | 0.2891%          |
| (b) Buchanan Coal Company<br>P.O. Box 187<br>Tazewell, VA 24651            | 3.0333 acres<br>1/9 of 27.30 acres  | 0.0643%          |
| (c) Sayers-Pocahontas Coal Company<br>P.O. Box 187<br>Tazewell, VA 24651   | 1.5167 acres<br>1/18 of 27.30 acres | 0.0321%          |
| (d) Buchanan Mining Company LLC*<br>PO Drawer L<br>Oakwood, VA 24630       | 9.1000 acres<br>1/3 of 27.30 acres  | 0.1928%          |

Note: Weyerhaeuser Company (previously Plum Creek Timberlands) retained their CBM interest

260000391

Revised Exhibit B  
 VS18  
 Docket #VGOB 23-1121-4277-01  
 List of all Owners/Claimants  
 (4,721.14 Acre Unit)

250000474

|  | Acres in Unit                       | Interest in Unit |
|--|-------------------------------------|------------------|
| <b><u>Tract #29 - 114.35 Acres</u></b>   |                                     |                  |
| (1) McGuire Hurt Heirs Trust<br>c/o Charles Green<br>15519 Lookout Ridge<br>Bristol, VA 24202-5080 | 114.35 acres                        | 2.4221%          |
| <b><u>Tract #30 - 16.35 Acres</u></b>  |                                     |                  |
| (1) Buchanan Mining Company LLC, et al   | 16.35 acres                         | 0.3463%          |
| (a) Yukon Pocahontas Coal Company<br>P.O. Box 187<br>Tazewell, VA 24651                            | 8.1750 acres<br>1/2 of 16.35 acres  | 0.1732%          |
| (b) Buchanan Coal Company<br>P.O. Box 187<br>Tazewell, VA 24651                                    | 1.8167 acres<br>1/9 of 16.35 acres  | 0.0385%          |
| (c) Sayers-Pocahontas Coal Company<br>P.O. Box 187<br>Tazewell, VA 24651                           | 0.9083 acres<br>1/18 of 16.35 acres | 0.0192%          |
| (d) Buchanan Mining Company LLC*<br>PO Drawer L<br>Oakwood, VA 24630                               | 5.4500 acres<br>1/3 of 16.35 acres  | 0.1154%          |
| <i>Note: Weyerhaeuser Company (previously Plum Creek Timberlands) retained their CBM interest</i>  |                                     |                  |
| <b><u>Tract #31 - 779.46 Acres</u></b>   |                                     |                  |
| (1) Commonwealth Coal Corporation<br>PO Box 1269<br>Bristol, VA 24203                              | 779.46 acres                        | 16.5100%         |
| <b><u>Tract #32 - 3.14 Acres</u></b>   |                                     |                  |
| (1) Coal Mountain Mining Company LLP<br>P.O. Box 675<br>Tazewell, VA 24651                         | 3.14 acres                          | 0.0665%          |
| <b><u>Tract #33 - 30.82 Acres</u></b>  |                                     |                  |
| (1) Coal Mountain Mining Company LLP<br>P.O. Box 675<br>Tazewell, VA 24651                         | 30.82 acres                         | 0.6528%          |
| <b><u>Tract #34 - 36.48 Acres</u></b>  |                                     |                  |
| (1) Coal Mountain Mining Company LLP<br>P.O. Box 675<br>Tazewell, VA 24651                         | 36.48 acres                         | 0.7727%          |
| <b><u>Tract #35 - 301.98 Acres</u></b>   |                                     |                  |
| (1) Commonwealth Coal Corporation<br>PO Box 1269<br>Bristol, VA 24203                              | 301.98 acres                        | 6.3963%          |
| <b><u>Tract #36 - 19.92 Acres</u></b>  |                                     |                  |
| (1) Commonwealth Coal Corporation<br>PO Box 1269<br>Bristol, VA 24203                              | 19.92 acres                         | 0.4219%          |

260000391

250000474

Revised Exhibit B  
VS18  
Docket #VGOB 23-1121-4277-01  
List of all Owners/Claimants  
(4,721.14 Acre Unit)

|  | Acres in Unit | Interest in Unit |
|--|---------------|------------------|
| <b><u>Tract #37 - 10.90 Acres</u></b>                                      |               |                  |
| (1) Commonwealth Coal Corporation<br>PO Box 1269<br>Bristol, VA 24203      | 10.90 acres   | 0.2309%          |
| <b><u>Tract #38 - 2.04 Acres</u></b>                                       |               |                  |
| (1) Commonwealth Coal Corporation<br>PO Box 1269<br>Bristol, VA 24203      | 2.04 acres    | 0.0432%          |
| <b><u>Tract #39 - 2.65 Acres</u></b>                                       |               |                  |
| (1) Commonwealth Coal Corporation<br>PO Box 1269<br>Bristol, VA 24203      | 2.65 acres    | 0.0561%          |
| <b><u>Tract #40 - 213.00 Acres</u></b>                                     |               |                  |
| (1) Commonwealth Coal Corporation<br>PO Box 1269<br>Bristol, VA 24203      | 213.00 acres  | 4.5116%          |
| <b><u>Tract #41 - 86.84 Acres</u></b>                                      |               |                  |
| (1) Commonwealth Coal Corporation<br>PO Box 1269<br>Bristol, VA 24203      | 86.84 acres   | 1.8394%          |
| <b><u>Tract #42 - 301.84 Acres</u></b>                                     |               |                  |
| (1) Commonwealth Coal Corporation<br>PO Box 1269<br>Bristol, VA 24203      | 301.84 acres  | 6.3934%          |
| <b><u>Tract #43 - 125.72 Acres</u></b>                                     |               |                  |
| (1) Coal Mountain Mining Company LLP<br>P.O. Box 675<br>Tazewell, VA 24651 | 125.72 acres  | 2.6629%          |
| <b><u>Tract #44 - 882.64 Acres</u></b>                                     |               |                  |
| (1) Commonwealth Coal Corporation<br>PO Box 1269<br>Bristol, VA 24203      | 882.64 acres  | 18.6955%         |
| <b><u>Tract #45 - 623.54 Acres</u></b>                                     |               |                  |
| (1) Coal Mountain Mining Company LLP<br>P.O. Box 675<br>Tazewell, VA 24651 | 623.54 acres  | 13.2074%         |
| <b>II. OIL &amp; GAS OWNERSHIP</b>   |               |                  |
| <b><u>Tract #1A - 1.75 Acres</u></b>                                       |               |                  |
| (1) Patricia Smith Cook, et al   |               |                  |
| (a) Mildred Ratliff Smith (DOD 1/28/2021)                                  | 1.75 acres    | 0.0371%          |

Remainder:

Conveyed by Deed of Gift dated 11/8/2016 and recorded 12/2/2016  
by instrument 160002211; Life Estate reserved to Mildred R. Smith

260000391

Revised Exhibit B  
 VS18  
 Docket #VGOB 23-1121-4277-01  
 List of all Owners/Claimants  
 (4,721.14 Acre Unit)

250000474

|   | Acres in Unit                     | Interest in Unit |
|---|-----------------------------------|------------------|
| (a.1) Patricia Smith Cook<br>728 W. Locust Street<br>Johnson City, TN 37604   | 0.5833 acres<br>1/3 of 1.75 acres | 0.0124%          |
| (a.2) Linda Kay Ratliff Smith<br>PO Box 192<br>Hurley, VA 24620   | 0.5833 acres<br>1/3 of 1.75 acres | 0.0124%          |
| (a.3) Sandra Smith Spears<br>69 Carefree Lane<br>Kilmarnock, VA 22485   | 0.5833 acres<br>1/3 of 1.75 acres | 0.0124%          |
| <b><u>Tract #1B - 3.59 Acres</u></b>  |                                   |                  |
| (1) Pocahontas Gas LLC<br>1000 Horizon Vue Drive, Ste 400<br>Canonsburg, PA 15317   | 3.59 acres                        | 0.0760%          |
| <b><u>Tract #2 - Transferred to Buch No 1 South 1 Panel SGU</u></b>   |                                   |                  |
| <b><u>Tract #3 - Transferred to Buch No 1 South 1 Panel SGU</u></b>   |                                   |                  |
| <b><u>Tract #4A - 1.32 Acres</u></b>  |                                   |                  |
| (1) Coal Mountain Mining Company LLP<br>P.O. Box 675<br>Tazewell, VA 24651  | 1.32 acres                        | 0.0280%          |
| <b><u>Tract #4B - 6.70 Acres</u></b>  |                                   |                  |
| (1) Coal Mountain Mining Company LLP<br>P.O. Box 675<br>Tazewell, VA 24651  | 6.70 acres                        | 0.1419%          |
| <b><u>Tract #4C - 1.57 Acres</u></b>  |                                   |                  |
| (1) Coal Mountain Mining Company LLP<br>P.O. Box 675<br>Tazewell, VA 24651  | 1.57 acres                        | 0.0333%          |
| <b><u>Tract #5 - 26.20 Acres</u></b>  |                                   |                  |
| (1) Pocahontas Gas LLC<br>1000 Horizon Vue Drive, Ste 400<br>Canonsburg, PA 15317   | 26.20 acres                       | 0.5550%          |
| <b><u>Tract #6 - Transferred to Buch No 1 South 1 Panel SGU</u></b>   |                                   |                  |
| <b><u>Tract #7 - 17.47 Acres</u></b>  |                                   |                  |
| <i>Note: CBM ownership was adjudicated to the prevailing plaintiffs under Case no. CL 11-0497-00<br/>The Corrected Final Order was executed September 29, 2011 and plaintiffs were awarded 100% of the<br/>Coalbed Methane Gas underlying this tract.</i> |                                   |                  |
| (1) Loya Edgar Davis Compton Heirs, Devisees,<br>Successors or Assigns<br>(71.75 acre tract)  | 17.47 acres                       | 0.3700%          |
| (a) Allie Davis Clowers<br>150 County Road 161<br>Riceville, TN 37370   | 2.18 acres<br>1/8 of 17.47 acres  | 0.0463%          |
| (b) Buford Davis Heirs, Devisees,<br>Successors, or Assigns   |                                   |                  |
| (b.1) Doris Davis<br>827 Green Acres Street<br>Pounding Mill, VA 24637  | 2.18 acres<br>1/8 of 17.47 acres  | 0.0463%          |

260000391

Revised Exhibit B  
 VS18  
 Docket #VGOB 23-1121-4277-01  
 List of all Owners/Claimants  
 (4,721.14 Acre Unit)

250000474

|  | Acres in Unit                     | Interest in Unit |
|--|-----------------------------------|------------------|
| (c) Billy D. Davis Heirs, Devisees, Successors or Assigns  |                                   |                  |
| (c.1) Billy Michael Davis<br>1839 W. Market Street<br>Smithfield, NC 27577   | 1.09 acres<br>1/16 of 17.47 acres | 0.0231%          |
| (c.2) Lisa Diane Davis<br>1839 W Market Street<br>Smithfield, NC 27577   | 1.09 acres<br>1/16 of 17.47 acres | 0.0231%          |
| (d) Joe Darrell Davis<br>1752 Sandy Gap Rd.<br>Raven, VA 24639   | 2.18 acres<br>1/8 of 17.47 acres  | 0.0463%          |
| (e) Bobby Davis<br>101 Able Road<br>Cedar Bluff, VA 24609  | 2.18 acres<br>1/8 of 17.47 acres  | 0.0463%          |
| (f) Gary Davis<br>1189 Point Road<br>Raven, VA 24639   | 2.18 acres<br>1/8 of 17.47 acres  | 0.0463%          |
| (g) Larry Wayne Davis<br>PO Box 183<br>Pounding Mill, VA 24637   | 2.18 acres<br>1/8 of 17.47 acres  | 0.0463%          |
| (h) Jimmy A. Davis Heirs, Devisees, Successors or Assigns  |                                   |                  |
| (h.1) Dorothy Davis, Sandy Barnette, Mark Davis, and Jimmy Davis, Jr.<br><i>Conveyed to (h.2) as tenants in entirety with right of survivorship, instrument# 100001037 dated 4/20/2010</i> |                                   |                  |
| (h.2) Larry Wayne and Jacqueline Davis, TE<br>PO Box 183<br>Pounding Mill, VA 24637  | 2.18 acres<br>1/8 of 17.47 acres  | 0.0463%          |
| <b><u>Tract #8 - 41.68 Acres</u></b>   |                                   |                  |
| (1) Coal Mountain Mining Company LLP<br>P.O. Box 675<br>Tazewell, VA 24651   | 41.68 acres                       | 0.8828%          |
| <b><u>Tract #9 - Transferred to Buch No 1 South 1 Panel SGU</u></b>  |                                   |                  |
| <b><u>Tract #10 - 56.40 Acres</u></b>  |                                   |                  |
| (1) Coal Mountain Mining Company LLP<br>P.O. Box 675<br>Tazewell, VA 24651   | 56.40 acres                       | 1.1946%          |
| <b><u>Tract #11 - 46.79 Acres</u></b>  |                                   |                  |
| (1) Coal Mountain Mining Company LLP<br>P.O. Box 675<br>Tazewell, VA 24651   | 46.79 acres                       | 0.9911%          |
| <b><u>Tract #12 - 5.17 Acres</u></b>   |                                   |                  |
| (1) Pocahontas Gas LLC<br>1000 Horizon Vue Drive, Ste 400<br>Canonsburg, PA 15317  | 5.17 acres                        | 0.1095%          |
| <b><u>Tract #13 - 86.43 Acres</u></b>  |                                   |                  |
| (1) Coal Mountain Mining Company LLP<br>P.O. Box 675<br>Tazewell, VA 24651   | 86.43 acres                       | 1.8307%          |

260000391

250000474

Revised Exhibit B  
 VS18  
 Docket #VGOB 23-1121-4277-01  
 List of all Owners/Claimants  
 (4,721.14 Acre Unit)

|   | Acres in Unit                       | Interest in Unit |
|---|-------------------------------------|------------------|
| <b><u>Tract #14 - 11.23 Acres</u></b>   |                                     |                  |
| (1) Weyerhaeuser Company, et al   | 11.23 acres                         | 0.2379%          |
| (a) Yukon Pocahontas Coal Company<br>P.O. Box 187<br>Tazewell, VA 24651                         | 5.6150 acres<br>1/2 of 11.23 acres  | 0.1189%          |
| (b) Buchanan Coal Company<br>P.O. Box 187<br>Tazewell, VA 24651                                 | 1.2478 acres<br>1/9 of 11.23 acres  | 0.0264%          |
| (c) Sayers-Pocahontas Coal Company<br>P.O. Box 187<br>Tazewell, VA 24651                        | 0.6239 acres<br>1/18 of 11.23 acres | 0.0132%          |
| (d) Weyerhaeuser Forest Holdings, Inc.<br>PO Box 750121<br>Atlanta, GA 30374-7921               | 3.7433 acres<br>1/3 of 11.23 acres  | 0.0793%          |
| <b><u>Tract #15 - 3.01 Acres</u></b>  |                                     |                  |
| (1) Commonwealth of Virginia<br>Department of Highways<br>2111 Bonham Road<br>Bristol, VA 24201 | 3.01 acres                          | 0.0638%          |
| <b><u>Tract #16 - 152.88 Acres</u></b>  |                                     |                  |
| (1) Coal Mountain Mining Company LLP<br>P.O. Box 675<br>Tazewell, VA 24651                      | 152.88 acres                        | 3.2382%          |
| <b><u>Tract #17 - 2.00 Acres</u></b>  |                                     |                  |
| (1) Pocahontas Gas LLC<br>1000 Horizon Vue Drive, Ste 400<br>Canonsburg, PA 15317               | 2.00 acres                          | 0.0424%          |
| <b><u>Tract #18 - 38.14 Acres</u></b>   |                                     |                  |
| (1) Coal Mountain Mining Company LLP<br>P.O. Box 675<br>Tazewell, VA 24651                      | 38.14 acres                         | 0.8079%          |
| <b><u>Tract #19 - 115.45 Acres</u></b>  |                                     |                  |
| (1) Coal Mountain Mining Company LLP<br>P.O. Box 675<br>Tazewell, VA 24651                      | 115.45 acres                        | 2.4454%          |
| <b><u>Tract #20 - 2.07 Acres</u></b>  |                                     |                  |
| (1) Thomas P. Stilwell<br>1898 Old Kentucky Turnpike Road<br>Raven, VA 24639                    | 2.07 acres                          | 0.0438%          |
| <b><u>Tract #21 - 162.41 Acres</u></b>  |                                     |                  |
| (1) Coal Mountain Mining Company LLP<br>P.O. Box 675<br>Tazewell, VA 24651                      | 162.41 acres                        | 3.4401%          |
| <b><u>Tract #22 - 35.17 Acres</u></b>   |                                     |                  |
| (1) Coal Mountain Mining Company LLP<br>P.O. Box 675<br>Tazewell, VA 24651                      | 35.17 acres                         | 0.7449%          |

260000391

Revised Exhibit B  
 VS18  
 Docket #VGOB 23-1121-4277-01  
 List of all Owners/Claimants  
 (4,721.14 Acre Unit)

250000474

|   | Acres in Unit                        | Interest in Unit |
|---|--------------------------------------|------------------|
| <b><u>Tract #23 - 7.12 Acres</u></b>  |                                      |                  |
| (1) Pocahontas Gas LLC, et al<br><i>(47.90 Acre Tract)</i>  | 7.12 acres                           | 0.1508%          |
| (a) Pocahontas Gas LLC<br>1000 Horizon Vue Drive, Ste 400<br>Canonsburg, PA 15317   | 7.014 acres<br>331/336 of 7.12 acres | 0.1486%          |
| (b) Ruie McGlothlin Heirs, Deviseses,<br>Successors, or Assigns   |                                      |                  |
| (b.1) Junior C. McGlothlin Heirs, Deviseses,<br>Successors, or Assigns  |                                      |                  |
| (b.1.1) Janet E. McGlothlin Heirs, Deviseses,<br>Successors, or Assigns   |                                      |                  |
| (b.1.1.1) Johnny Dwight McGlothlin<br>820 Baptist Valley Road<br>Cedar Bluff, VA 24609  | 0.011 acres<br>1/672 of 7.12 acres   | 0.0002%          |
| (b.2) Helen Adams Heirs, Deviseses,<br>Successors, or Assigns<br><i>(Documentation Pending)</i>   | 0.032 acres<br>1/224 of 7.12 acres   | 0.0007%          |
| (b.2.1) Bernie Gene Adams<br>14309 Phoenix Road<br>Phoenix, MD 21131  |                                      |                  |
| (b.2.2) Michael Adams<br>220 E Lakeview Street<br>Umatilla, FL 32784  |                                      |                  |
| (b.3) Ruby Lee Zwald Heirs, Deviseses,<br>Successors, or Assigns  |                                      |                  |
| (b.3.1) Walter Lawrence Finney Heirs,<br>Deviseses, Successors, or Assigns  |                                      |                  |
| (b.3.1.1) Shelby Ann Finney<br><i>Conveyed to Cheryl Keen Tucker and Bernie Gene Adams as tenants in common, RC - Instr# 220001375. BC - Instr# 2200000738.<br/>TC - Instr# 220001829, all dated 6/6/2022</i> |                                      |                  |
| (b.3.1.1.1) Cheryl Keen Tucker<br>170 Charleston Place<br>Daleville, VA 24083   | 0.016 acres<br>1/448 of 7.12 acres   | 0.0003%          |
| (b.3.1.1.2) Bernie Gene Adams<br>14309 Phoenix Road<br>Phoenix, MD 21131  | 0.016 acres<br>1/448 of 7.12 acres   | 0.0003%          |
| (b.4) Mary R. Barnett Heirs, Deviseses,<br>Successors, or Assigns   |                                      |                  |
| (b.4.1) Cheryl Keen Tucker<br>170 Charleston Place<br>Daleville, VA 24083   | 0.032 acres<br>1/224 of 7.12 acres   | 0.0007%          |
| <b><u>Tract #24 - 91.31 Acres</u></b>   |                                      |                  |
| (1) Coal Mountain Mining Company LLP<br>P.O. Box 675<br>Tazewell, VA 24651  | 91.31 acres                          | 1.9341%          |

260000391

Revised Exhibit B  
 VS18  
 Docket #VGOB 23-1121-4277-01  
 List of all Owners/Claimants  
 (4,721.14 Acre Unit)

250000474

|   | Acres in Unit                       | Interest in Unit |
|---|-------------------------------------|------------------|
| <b><u>Tract #25 - 134.88 Acres</u></b>  |                                     |                  |
| (1) Coal Mountain Mining Company LLP<br>P.O. Box 675<br>Tazewell, VA 24651                            | 134.88 acres                        | 2.8569%          |
| <b><u>Tract #26 - 39.28 Acres</u></b>   |                                     |                  |
| (1) Connie Davidson<br>127 Apache Lane, Apt 25<br>Marion, VA 24354                                    | 39.28 acres                         | 0.8320%          |
| <b><u>Tract #27 - 52.15 Acres</u></b>   |                                     |                  |
| (1) Coal Mountain Mining Company LLP<br>P.O. Box 675<br>Tazewell, VA 24651                            | 52.15 acres                         | 1.1046%          |
| <b><u>Tract #28 - 27.30 Acres</u></b>   |                                     |                  |
| (1) Weyerhaeuser Company, et al   | 27.30 acres                         | 0.5783%          |
| (a) Yukon Pocahontas Coal Company<br>P.O. Box 187<br>Tazewell, VA 24651                               | 13.6500 acres<br>1/2 of 27.30 acres | 0.2891%          |
| (b) Buchanan Coal Company<br>P.O. Box 187<br>Tazewell, VA 24651                                       | 3.0333 acres<br>1/9 of 27.30 acres  | 0.0643%          |
| (c) Sayers-Pocahontas Coal Company<br>P.O. Box 187<br>Tazewell, VA 24651                              | 1.5167 acres<br>1/18 of 27.30 acres | 0.0321%          |
| (d) Weyerhaeuser Forest Holdings, Inc.<br>PO Box 750121<br>Atlanta, GA 30374-7921                     | 9.1000 acres<br>1/3 of 27.30 acres  | 0.1928%          |
| <b><u>Tract #29A - 5.59 Acres</u></b>   |                                     |                  |
| (1) Janice L. & Jeremy W. Davis, TE<br>1011 Betsy Branch Road<br>Raven, VA 24639                      | 5.59 acres                          | 0.1184%          |
| <b><u>Tract #29B - 3.74 Acres</u></b>   |                                     |                  |
| (1) William & Hannalore Engardio, T/E<br>3187 Riverside Drive<br>Raven, VA 24639                      | 3.74 acres                          | 0.0792%          |
| <b><u>Tract #29C - 3.80 Acres</u></b>   |                                     |                  |
| (1) Pocahontas Gas LLC<br>1000 Horizon Vue Drive, Ste 400<br>Canonsburg, PA 15317                     | 3.80 acres                          | 0.0805%          |
| <b><u>Tract #29D - 1.24 Acres</u></b>   |                                     |                  |
| (1) Danny Wayne Hinkle<br>PO Box 571<br>Oakwood, VA 24631   | 1.24 acres                          | 0.0263%          |
| <b><u>Tract #29E - 9.87 Acres</u></b>   |                                     |                  |
| (1) Commonwealth of Virginia<br>Department of Transportation<br>2111 Bonham Road<br>Bristol, VA 24201 | 9.87 acres                          | 0.2091%          |

260000391

Revised Exhibit B  
 VS18  
 Docket #VGOB 23-1121-4277-01  
 List of all Owners/Claimants  
 (4,721.14 Acre Unit)

250000474

|   | Acres in Unit | Interest in Unit |
|---|---------------|------------------|
| <b><u>Tract #29F - 3.97 Acres</u></b>   |               |                  |
| (1) Russell V. and Anita Presley, TE<br>PO Box 463<br>Keen Mountain, VA 24624                         | 3.97 acres    | 0.0841%          |
| <b><u>Tract #29G - 0.08 Acres</u></b>   |               |                  |
| (1) Jadco, Inc.<br>3081 Riverside Drive<br>Raven, VA 24639  | 0.08 acres    | 0.0017%          |
| <b><u>Tract #29H - 0.61 Acres</u></b>   |               |                  |
| (1) Jadco, Inc.<br>3081 Riverside Drive<br>Raven, VA 24639  | 0.61 acres    | 0.0129%          |
| <b><u>Tract #29I - 0.23 Acres</u></b>   |               |                  |
| (1) Jadco, Inc.<br>3081 Riverside Drive<br>Raven, VA 24639  | 0.23 acres    | 0.0049%          |
| <b><u>Tract #29J - 0.02 Acres</u></b>   |               |                  |
| (1) Pocahontas Gas LLC<br>1000 Horizon Vue Drive, Ste 400<br>Canonsburg, PA 15317                     | 0.02 acres    | 0.0004%          |
| <b><u>Tract #29K - 47.18 Acres</u></b>  |               |                  |
| (1) Pocahontas Gas LLC<br>1000 Horizon Vue Drive, Ste 400<br>Canonsburg, PA 15317                     | 47.18 acres   | 0.9993%          |
| <b><u>Tract #29L - 1.16 Acres</u></b>   |               |                  |
| (1) Joel D. & Brenda L. Burke<br>PO Box 33<br>Rowe, VA 24646  | 1.16 acres    | 0.0246%          |
| <b><u>Tract #29M - 4.54 Acres</u></b>   |               |                  |
| (1) Pocahontas Gas LLC<br>1000 Horizon Vue Drive, Ste 400<br>Canonsburg, PA 15317                     | 4.54 acres    | 0.0962%          |
| <b><u>Tract #29N - 2.33 Acres</u></b>   |               |                  |
| (1) Pocahontas Gas LLC<br>1000 Horizon Vue Drive, Ste 400<br>Canonsburg, PA 15317                     | 2.33 acres    | 0.0494%          |
| <b><u>Tract #29O - 1.98 Acres</u></b>   |               |                  |
| (1) Commonwealth of Virginia<br>Department of Transportation<br>2111 Bonham Road<br>Bristol, VA 24201 | 1.98 acres    | 0.0419%          |
| <b><u>Tract #29P - 10.54 Acres</u></b>  |               |                  |
| (1) Pocahontas Gas LLC<br>1000 Horizon Vue Drive, Ste 400<br>Canonsburg, PA 15317                     | 10.54 acres   | 0.2233%          |

260000391

Revised Exhibit B  
 VS18  
 Docket #VGOB 23-1121-4277-01  
 List of all Owners/Claimants  
 (4,721.14 Acre Unit)

250000474

|   | Acres in Unit                     | Interest in Unit |
|---|-----------------------------------|------------------|
| <b><u>Tract #29Q - 1.21 Acres</u></b>   |                                   |                  |
| (1) Pocahontas Gas LLC<br>1000 Horizon Vue Drive, Ste 400<br>Canonsburg, PA 15317                     | 1.21 acres                        | 0.0256%          |
| <b><u>Tract #29R - 0.50 Acres</u></b>   |                                   |                  |
| (1) Commonwealth of Virginia<br>Department of Transportation<br>2111 Bonham Road<br>Bristol, VA 24201 | 0.50 acres                        | 0.0106%          |
| <b><u>Tract #29S - 0.68 Acres</u></b>   |                                   |                  |
| (1) Commonwealth of Virginia<br>Department of Transportation<br>2111 Bonham Road<br>Bristol, VA 24201 | 0.68 acres                        | 0.0144%          |
| <b><u>Tract #29T - 7.31 Acres</u></b>   |                                   |                  |
| (1) Donald Ray Young<br>1066 E Cross Roads Drive<br>Lebanon, VA 24266                                 | 7.31 acres                        | 0.1548%          |
| <b><u>Tract #29U - 3.39 Acres</u></b>   |                                   |                  |
| (1) Patrick Counts<br>1665 Riverside Drive<br>Raven, VA 24639   | 3.39 acres                        | 0.0718%          |
| <b><u>Tract #29V - 1.49 Acres</u></b>   |                                   |                  |
| (1) Pocahontas Gas LLC<br>1000 Horizon Vue Drive, Ste 400<br>Canonsburg, PA 15317                     | 1.49 acres                        | 0.0316%          |
| <b><u>Tract #29W - 0.90 Acres</u></b>   |                                   |                  |
| (1) Grady W. & Pauline J. McGlothlin<br>PO Box 955<br>Raven, VA 24639                                 | 0.90 acres                        | 0.0191%          |
| <b><u>Tract #29X - 1.10 Acres</u></b>   |                                   |                  |
| (1) Commonwealth of Virginia<br>Department of Transportation<br>2111 Bonham Road<br>Bristol, VA 24201 | 1.10 acres                        | 0.0233%          |
| <b><u>Tract #29Y - 0.89 Acres</u></b>   |                                   |                  |
| (1) Oris Cantrell Heirs, devisees,<br>Successors, or Assigns  | 0.89 acres                        | 0.0189%          |
| (a) Amy Mae Hess<br>PO Box 922<br>Vansant, VA 24656   | 0.2225 acres<br>1/4 of 0.89 acres | 0.0047%          |
| (b) Jamie Cantrell<br>282 Westview Street<br>Pounding Mill, VA 24637                                  | 0.2225 acres<br>1/4 of 0.89 acres | 0.0047%          |
| (c) Penny Falck<br>2390 Glade Drive<br>Christiansburg, VA 24073                                       | 0.2225 acres<br>1/4 of 0.89 acres | 0.0047%          |

260000391

250000474

Revised Exhibit B  
VS18  
Docket #VGOB 23-1121-4277-01  
List of all Owners/Claimants  
(4,721.14 Acre Unit)

|  | Acres in Unit                          | Interest in Unit |
|--|--|------------------|
| (d) Cathleen Arrington<br>7342 Pine Street<br>Radford, VA 24141                                | 0.2225 acres<br>1/4 of 0.89 acres      | 0.0047%          |
| <b><u>Tract #30 - 16.35 Acres</u></b>  |  |                  |
| (1) Weyerhaeuser Company, et al  | 16.35 acres                            | 0.3463%          |
| (a) Yukon Pocahontas Coal Company<br>P.O. Box 187<br>Tazewell, VA 24651                        | 8.1750 acres<br>1/2 of 16.35 acres     | 0.1732%          |
| (b) Buchanan Coal Company<br>P.O. Box 187<br>Tazewell, VA 24651                                | 1.8167 acres<br>1/9 of 16.35 acres     | 0.0385%          |
| (c) Sayers-Pocahontas Coal Company<br>P.O. Box 187<br>Tazewell, VA 24651                       | 0.9083 acres<br>1/18 of 16.35 acres    | 0.0192%          |
| (d) Weyerhaeuser Forest Holdings, Inc.<br>PO Box 750121<br>Atlanta, GA 30374-7921              | 5.4500 acres<br>1/3 of 16.35 acres     | 0.1154%          |
| <b><u>Tract #31 - 779.46 Acres</u></b>   |  |                  |
| (1) Commonwealth Coal Corporation<br>PO Box 1269<br>Bristol, VA 24203                          | 779.46 acres                           | 16.5100%         |
| <b><u>Tract #32 - 3.14 Acres</u></b>   |  |                  |
| (1) Coal Mountain Mining Company LLP<br>P.O. Box 675<br>Tazewell, VA 24651                     | 3.14 acres                             | 0.0665%          |
| <b><u>Tract #33A - 26.89 Acres</u></b>   |  |                  |
| (1) Pocahontas Gas LLC, et al<br><i>(37.00 Acre Tract)</i>                                     | 26.89 acres                            | 0.5696%          |
| (a) Pocahontas Gas LLC<br>1000 Horizon Vue Drive, Ste 400<br>Canonsburg, PA 15317              | 26.490 acres<br>331/336 of 26.89 acres | 0.5611%          |
| (b) Ruie McGlothlin Heirs, Devisees,<br>Successors, or Assigns                                 |  |                  |
| (b.1) Junior C. McGlothlin Heirs, Devisees,<br>Successors, or Assigns                          |  |                  |
| (b.1.1) Janet E. McGlothlin Heirs, Devisees,<br>Successors, or Assigns                         |  |                  |
| (b.1.1.1) Johnny Dwight McGlothlin<br>820 Baptist Valley Road<br>Cedar Bluff, VA 24609         | 0.040 acres<br>1/672 of 26.89 acres    | 0.0008%          |
| (b.2) Helen Adams Heirs, Devisees,<br>Successors, or Assigns<br><i>(Documentation Pending)</i> | 0.120 acres<br>1/224 of 26.89 acres    | 0.0025%          |
| (b.2.1) Bernie Gene Adams<br>14309 Phoenix Road<br>Phoenix, MD 21131                           |  |                  |
| (b.2.2) Michael Adams<br>220 E Lakeview Street<br>Umatilla, FL 32784                           |  |                  |

260000391

250000474

Revised Exhibit B  
VS18  
Docket #VGOB 23-1121-4277-01  
List of all Owners/Claimants  
(4.721.14 Acre Unit)

|   | Acres in Unit                       | Interest in Unit |
|---|-------------------------------------|------------------|
| (b.3) Ruby Lee Zwald Heirs, Devisees, Successors, or Assigns  |                                     |                  |
| (b.3.1) Walter Lawrence Finney Heirs, Devisees, Successors, or Assigns  |                                     |                  |
| (b.3.1.1) Shelby Ann Finney<br><i>Conveyed to Cheryl Keen Tucker and Bernie Gene Adams as tenants in common, RC - instr# 220001375, BC - instr# 2200000738, TC - instr# 220001829, all dated 6/6/2022</i> |                                     |                  |
| (b.3.1.1.1) Cheryl Keen Tucker<br>170 Charleston Place<br>Daleville, VA 24083   | 0.060 acres<br>1/448 of 26.89 acres | 0.0013%          |
| (b.3.1.1.2) Bernie Gene Adams<br>14309 Phoenix Road<br>Phoenix, MD 21131  | 0.060 acres<br>1/448 of 26.89 acres | 0.0013%          |
| (b.4) Mary R. Barnett Heirs, Devisees, Successors, or Assigns   |                                     |                  |
| (b.4.1) Cheryl Keen Tucker<br>170 Charleston Place<br>Daleville, VA 24083   | 0.120 acres<br>1/224 of 26.89 acres | 0.0025%          |
| <b><u>Tract #33B - 2.31 Acres</u></b>   |                                     |                  |
| (1) Commonwealth of Virginia<br>Department of Transportation<br>2111 Bonham Road<br>Bristol, VA 24201   | 2.31 acres                          | 0.0489%          |
| <b><u>Tract #33C - 1.62 Acres</u></b>   |                                     |                  |
| (1) Jimmy Lee McGlothlin<br>PO Box 987<br>Raven, VA 24639   | 1.62 acres                          | 0.0343%          |
| <b><u>Tract #34 - 36.48 Acres</u></b>   |                                     |                  |
| (1) Coal Mountain Mining Company LLP<br>P.O. Box 675<br>Tazewell, VA 24651  | 36.48 acres                         | 0.7727%          |
| <b><u>Tract #35 - 301.98 Acres</u></b>  |                                     |                  |
| (1) Commonwealth Coal Corporation<br>PO Box 1269<br>Bristol, VA 24203   | 301.98 acres                        | 6.3963%          |
| <b><u>Tract #36A - 19.31 Acres</u></b>  |                                     |                  |
| (1) Bernard Shortt, et al - Tax map# 064A0035   | 19.31 acres                         | 0.4090%          |
| (a) Roy Bernard and Linda Ruth Shortt<br>Roy Bernard Shortt (DOD 11/2/2024)   |                                     |                  |
| Linda Ruth Shortt<br>642 Shortts Road<br>Raven, VA 24639  |                                     | Life Estate      |
| (b) Joshua Andrew Shortt* (DOD 8/25/2021)   |                                     |                  |
| (c) Barney Andrew Shortt*<br>728 Shortts Road<br>Raven, VA 24639  | 9.655 acres<br>1/2 of 19.31 acres   | 0.2045%          |

260000391

Revised Exhibit B  
VS18  
Docket #VGOB 23-1121-4277-01  
List of all Owners/Claimants  
(4,721.14 Acre Unit)

250000474

|   | Acres in Unit                      | Interest in Unit |
|---|------------------------------------|------------------|
| (d) Janet Shortt*<br>728 Shortts Road<br>Raven, VA 24639<br><i>*Josua Andrew Shortt, Barney Andrew Shortt, and Janet Shortt were conveyed ownership as joint tenants with right of survivorship</i>   | 9.655 acres<br>1/2 of 19.31 acres  | 0.2045%          |
| <b><u>Tract #36B - 0.19 Acres</u></b>   |                                    |                  |
| (1) Barney Shortt, et al  |                                    |                  |
| (a) Roy Bernard and Linda Ruth Shortt<br>Roy Bernard Shortt (DOD 11/2/2024)   |                                    |                  |
| Linda Ruth Shortt<br>642 Shortts Road<br>Raven, VA 24639  | Life Estate                        |                  |
| (b) Barney Andrew and Janet Shortt**<br>728 Shortts Road<br>Raven, VA 24639<br><i>**Tenants in entirety with right of survivorship</i>  | 0.19 acres                         | 0.0040%          |
| <b><u>Tract #36C - 0.42 Acres</u></b>   |                                    |                  |
| <i>***Cloud on Title - When Tom Short acquired title to the parent tract of which this property is a portion, he also obtained title to the gas and oil. He then conveyed the property to his wife (Bertha) and reserved all minerals in DB 190/119. Bertha later conveyed back to Tom in DB 217/438, with the same reservation language, though she owned no mineral to reserve. Tom again conveyed to Bertha in DB 281/12, reserving all mineral. Bertha again conveyed to Tom in DB 331/248, and again reserved mineral she did not own. Tom Short and Bertha Short conveyed to Walter M. Short and Jeanette H. Short, in DB 342/400, a 3.2 acre parcel, referencing as the source of title DB 331/248 wherein Bertha reserved mineral she did not own, as the mineral reservation language. The intent of Bertha and Tom Short may have been to reserve all mineral, however, the source reservation language reference within DB 342/400 fails. Correction deeds are necessary to vest title to the oil and gas in either the heirs of Tom Short, or the current surface owners, Robert and Jackie Rose.</i> |                                    |                  |
| (1) Walter Shortt, et al  | 0.42 acres                         | 0.0089%          |
| (a) Tommy Arnold Shortt<br>PO Box 1228<br>Richlands, VA 24641   | 0.0382 acres<br>1/11 of 0.42 acres | 0.0008%          |
| (b) Walter Mervin Shortt Heirs, Devisees,<br>Successors, or Assigns   |                                    |                  |
| (b.1) Mervin Shortt<br>815 W Thornwood Drive<br>South Elgin, IL 60177   | 0.0127 acres<br>1/33 of 0.42 acres | 0.0003%          |
| (b.2) Linda F. Grasso<br>4016 Silk Oak Lane<br>Palm Harbor, FL 34685  | 0.0127 acres<br>1/33 of 0.42 acres | 0.0003%          |
| (b.3) Larry Walter Short  | pre-deceased                       |                  |
| (b.3.1) Larry Short, Jr.<br>436 Waverly Street<br>Kingsford, MI 49802   | 0.0064 acres<br>1/66 of 0.42 acres | 0.0001%          |
| (b.3.2) Tamara Beth Ham<br>108 Chesterfield Drive<br>Pinehurst, NC 28374  | 0.0064 acres<br>1/66 of 0.42 acres | 0.0001%          |
| (c) Harold B. Shortt Heirs, Devisees,<br>Successors, or Assigns   |                                    |                  |
| (c.1) Charlene Shortt<br>PO Box 1818<br>Cedar Bluff, VA 24609   | 0.0382 acres<br>1/11 of 0.42 acres | 0.0008%          |

260000391

Revised Exhibit B  
 VS18  
 Docket #VGOB 23-1121-4277-01  
 List of all Owners/Claimants  
 (4,721.14 Acre Unit)

250000474

|   | Acres in Unit                      | Interest in Unit |
|---|------------------------------------|------------------|
| (d) Glenward Jason Shortt<br>128 And Street<br>Pounding Mill, VA 24637                                      | 0.0382 acres<br>1/11 of 0.42 acres | 0.0008%          |
| (e) Ballard Charlie Shortt Heirs, Deivsees,<br>Successors, or Assigns                                       |                                    |                  |
| (h.1) Earlean Shortt Heirs, Deivsees,<br>Successors, or Assigns<br><i>(Documentation Pending)</i>           | 0.0382 acres<br>1/11 of 0.42 acres | 0.0008%          |
| (h.1.1) Becky Harris<br>105 Windlass Court<br>Moneta, VA 24121  |                                    |                  |
| (f) Dorothy Short Keene<br>279 Townview Drive<br>Lebanon, VA 24266  | 0.0382 acres<br>1/11 of 0.42 acres | 0.0008%          |
| (g) Maudie Short Bronson Heirs, Deivsees,<br>Successors, or Assigns   |                                    |                  |
| (g.1) Kenneth Wingo<br>1509 East Blow Road<br>Signal Mountain, TN 37377                                     | 0.0382 acres<br>1/11 of 0.42 acres | 0.0008%          |
| (h) Effie Shortt Heirs, Deivsees,<br>Successors, or Assigns   |                                    |                  |
| (h.1) Garnie Jean Thomas<br>PO Box 745<br>Doran, VA 24612   | 0.0382 acres<br>1/11 of 0.42 acres | 0.0008%          |
| (i) Garnie Jean Thomson <i>Conveyed 11/26/1997 to Harold Short and Glenward Short as JTWROS, DB 472/104</i> |                                    |                  |
| (i.1) Harold B. Short <i>(DOD 1/6/2017)</i>   |                                    |                  |
| (i.2) Glenward Jason Short<br>128 And Street<br>Pounding Mill, VA 24637                                     | 0.0382 acres<br>1/11 of 0.42 acres | 0.0008%          |
| (j) Otis Herbert Shortt Heirs, Deivsees,<br>Successors, or Assigns<br><i>(Documentation Pending)</i>        | 0.0382 acres<br>1/11 of 0.42 acres | 0.0008%          |
| (k) Raymond B. Short Heirs, Deivsees,<br>Successors, or Assigns   |                                    |                  |
| (k.1) Dalcie Norene Short Heirs, Deivsees,<br>Successors, or Assigns  |                                    |                  |
| (k.1.1) Grover Cleveland Elswick<br>5220 Looking Glass Trail<br>Denver, NC 28037                            | 0.0191 acres<br>1/22 of 0.42 acres | 0.0004%          |
| (k.1.2) Heather Norene Thornburg<br>1515 Town N Country Drive<br>Wilkesboro, NC 28697                       | 0.0191 acres<br>1/22 of 0.42 acres | 0.0004%          |
| OR  |                                    |                  |
| (1) Robert and Jackie Rose<br>1008 Shortts Road<br>Raven, VA 24639  | 0.42 acres                         | 0.0089%          |

260000391

Revised Exhibit B  
VS18  
Docket #VGOB 23-1121-4277-01  
List of all Owners/Claimants  
(4,721.14 Acre Unit)

250000474

|  | Acres in Unit                      | Interest in Unit |
|--|------------------------------------|------------------|
| <b>Tract #37A - 0.76 Acres</b>   |                                    |                  |
| ***Cloud on Title - When Tom Short acquired title to the parent tract of which this property is a portion, he also obtained title to the gas and oil. He then conveyed the property to his wife (Bertha) and reserved all minerals in DB 190/119. Bertha later conveyed back to Tom in DB 217/438, with the same reservation language, though she owned no mineral to reserve. Tom again conveyed to Bertha in DB 281/12, reserving all mineral. Bertha again conveyed to Tom in DB 331/248, and again reserved mineral she did not own. Tom Short and Bertha Short conveyed to Walter M. Short and Jeanette H. Short, in DB 342/400, a 3.2 acre parcel, referencing as the source of title DB 331/248 wherein Bertha reserved mineral she did not own, as the mineral reservation language. The intent of Bertha and Tom Short may have been to reserve all mineral, however, the source reservation language reference within DB 342/400 fails. Correction deeds are necessary to vest title to the oil and gas in either the heirs of Tom Short, or the current surface owners, Robert and Jackie Rose. |                                    |                  |
| (1) Walter Shortt, et al   | 0.76 acres                         | 0.0161%          |
| (a) Tommy Arnold Shortt<br>PO Box 1228<br>Richlands, VA 24641  | 0.0691 acres<br>1/11 of 0.76 acres | 0.0015%          |
| (b) Walter Mervin Shortt Heirs, Devisees,<br>Successors, or Assigns  |                                    |                  |
| (b.1) Mervin Shortt<br>815 W Thornwood Drive<br>South Elgin, IL 60177  | 0.0230 acres<br>1/33 of 0.76 acres | 0.0005%          |
| (b.2) Linda F. Grasso<br>4016 Silk Oak Lane<br>Palm Harbor, FL 34685   | 0.0230 acres<br>1/33 of 0.76 acres | 0.0005%          |
| (b.3) Larry Walter Short   | <i>pre-deceased</i>                |                  |
| (b.3.1) Larry Short, Jr.<br>436 Waverly Street<br>Kingsford, MI 49802  | 0.0115 acres<br>1/66 of 0.76 acres | 0.0002%          |
| (b.3.2) Tamara Beth Ham<br>108 Chesterfield Drive<br>Pinehurst, NC 28374   | 0.0115 acres<br>1/66 of 0.76 acres | 0.0002%          |
| (c) Harold B. Shortt Heirs, Devisees,<br>Successors, or Assigns  |                                    |                  |
| (c.1) Charlene Shortt<br>PO Box 1818<br>Cedar Bluff, VA 24609  | 0.0691 acres<br>1/11 of 0.76 acres | 0.0015%          |
| (d) Glenward Jason Shortt<br>128 And Street<br>Pounding Mill, VA 24637   | 0.0691 acres<br>1/11 of 0.76 acres | 0.0015%          |
| (e) Ballard Charlie Shortt Heirs, Devisees,<br>Successors, or Assigns  |                                    |                  |
| (n.1) Earlean Shortt Heirs, Devisees,<br>Successors, or Assigns<br><i>(Documentation Pending)</i>  | 0.0691 acres<br>1/11 of 0.76 acres | 0.0015%          |
| (h.1.1) Becky Harris<br>105 Windlass Court<br>Moneta, VA 24121   |                                    |                  |
| (f) Dorothy Short Keene<br>279 Townview Drive<br>Lebanon, VA 24266   | 0.0691 acres<br>1/11 of 0.76 acres | 0.0015%          |
| (g) Maudie Short Bronson Heirs, Devisees,<br>Successors, or Assigns  |                                    |                  |

260000391

Revised Exhibit B  
 VS18  
 Docket #VGOB 23-1121-4277-01  
 List of all Owners/Claimants  
 (4,721.14 Acre Unit)

250000474

|  | Acres in Unit  | Interest in Unit |
|--|--|------------------|
| (g.1) Kenneth Wingo<br>1509 East Blow Road<br>Signal Mountain, TN 37377                              | 0.0691 acres<br>1/11 of 0.76 acres   | 0.0015%          |
| (h) Effie Shortt Heirs, Devisees,<br>Successors, or Assigns  |  |                  |
| (h.1) Garnie Jean Thomas<br>PO Box 745<br>Doran, VA 24612  | 0.0691 acres<br>1/11 of 0.76 acres   | 0.0015%          |
| (i) Garnie Jean Thomson  | <i>Conveyed 11/26/1997 to Harold Shortt and Glenward Shortt as JTWRROS, DB 472/104</i> |                  |
| (i.1) Harold B. Shortt   | <i>(DOD 1/6/2017)</i>  |                  |
| (i.2) Glenward Jason Short<br>128 And Street<br>Pounding Mill, VA 24637                              | 0.0691 acres<br>1/11 of 0.76 acres   | 0.0015%          |
| (j) Otis Herbert Shortt Heirs, Devisees,<br>Successors, or Assigns<br><i>(Documentation Pending)</i> | 0.0691 acres<br>1/11 of 0.76 acres   | 0.0015%          |
| (k) Raymond B. Short Heirs, Devisees,<br>Successors, or Assigns                                      |  |                  |
| (k.1) Delcie Norene Short Heirs, Devisees,<br>Successors, or Assigns                                 |  |                  |
| (k.1.1) Grover Cleveland Elswick<br>5220 Looking Glass Trail<br>Denver, NC 28037                     | 0.0345 acres<br>1/22 of 0.76 acres   | 0.0007%          |
| (k.1.2) Heather Norene Thornburg<br>1515 Town N Country Drive<br>Wilkesboro, NC 28697                | 0.0345 acres<br>1/22 of 0.76 acres   | 0.0007%          |
| <b>OR</b>  |  |                  |
| (1) Robert and Jackie Rose<br>1008 Shortts Road<br>Raven, VA 24639                                   | 0.76 acres   | 0.0161%          |
| <b><u>Tract #37B - 8.89 Acres</u></b>  |  |                  |
| (1) Walter Shortt, et al   | 8.89 acres   | 0.1883%          |
| (a) Tommy Arnold Shortt<br>PO Box 1228<br>Richlands, VA 24641  | 0.8082 acres<br>1/11 of 8.89 acres   | 0.0171%          |
| (b) Walter Mervin Shortt Heirs, Devisees,<br>Successors, or Assigns                                  |  |                  |
| (b.1) Mervin Shortt<br>815 W Thornwood Drive<br>South Elgin, IL 60177                                | 0.2694 acres<br>1/33 of 8.89 acres   | 0.0057%          |
| (b.2) Linda F. Grasso<br>4016 Silk Oak Lane<br>Palm Harbor, FL 34685                                 | 0.2694 acres<br>1/33 of 8.89 acres   | 0.0057%          |
| (b.3) Larry Walter Short   | <i>pre-deceased</i>  |                  |
| (b.3.1) Larry Short, Jr.<br>436 Waverly Street<br>Kingsford, MI 49802                                | 0.1347 acres<br>1/66 of 8.89 acres   | 0.0029%          |

260000391

Revised Exhibit B  
 VS18  
 Docket #VGOB 23-1121-4277-01  
 List of all Owners/Claimants  
 (4,721.14 Acre Unit)

250000474

|   | Acres in Unit   | Interest in Unit |
|---|---|------------------|
| (b.3.2) Tamara Beth Ham<br>108 Chesterfield Drive<br>Pinehurst, NC 28374                            | 0.1347 acres<br>1/66 of 8.89 acres  | 0.0029%          |
| (c) Harold B. Shortt Heirs, Devises,<br>Successors, or Assigns                                      |   |                  |
| (c.1) Charlene Shortt<br>PO Box 1818<br>Cedar Bluff, VA 24609                                       | 0.8082 acres<br>1/11 of 8.89 acres  | 0.0171%          |
| (d) Glenward Jason Shortt<br>128 And Street<br>Pounding Mill, VA 24637                              | 0.8082 acres<br>1/11 of 8.89 acres  | 0.0171%          |
| (e) Ballard Charlie Shortt Heirs, Devises,<br>Successors, or Assigns                                |   |                  |
| (h.1) Earlean Shortt Heirs, Devises,<br>Successors, or Assigns<br><i>(Documentation Pending)</i>    | 0.8082 acres<br>1/11 of 8.89 acres  | 0.0171%          |
| (h.1.1) Becky Harris<br>105 Winclass Court<br>Moneta, VA 24121                                      |   |                  |
| (f) Dorothy Short Keene<br>279 Townview Drive<br>Lebanon, VA 24266                                  | 0.8082 acres<br>1/11 of 8.89 acres  | 0.0171%          |
| (g) Maudie Short Bronson Heirs, Devises,<br>Successors, or Assigns                                  |   |                  |
| (g.1) Kenneth Wingo<br>1509 East Blow Road<br>Signal Mountain, TN 37377                             | 0.8082 acres<br>1/11 of 8.89 acres  | 0.0171%          |
| (h) Effie Shortt Heirs, Devises,<br>Successors, or Assigns  |   |                  |
| (h.1) Garnie Jean Thomas<br>PO Box 745<br>Doran, VA 24612   | 0.8082 acres<br>1/11 of 8.89 acres  | 0.0171%          |
| (i) Garnie Jean Thomson   | <i>Conveyed 11/26/1997 to Harold Shortt and Glenward Shortt as JTWR0S, DB 472/104</i> |                  |
| (i.1) Harold B. Shortt  | <i>(DOD 1/6/2017)</i>   |                  |
| (i.2) Glenward Jason Shortt<br>128 And Street<br>Pounding Mill, VA 24637                            | 0.8082 acres<br>1/11 of 8.89 acres  | 0.0171%          |
| (j) Otis Herbert Shortt Heirs, Devises,<br>Successors, or Assigns<br><i>(Documentation Pending)</i> | 0.8082 acres<br>1/11 of 8.89 acres  | 0.0171%          |
| (k) Raymond B. Short Heirs, Devises,<br>Successors, or Assigns                                      |   |                  |
| (k.1) Delcie Norene Short Heirs, Devises,<br>Successors, or Assigns                                 |   |                  |
| (k.1.1) Grover Cleveland Elswick<br>5220 Looking Glass Trail<br>Denver, NC 28037                    | 0.4041 acres<br>1/22 of 8.89 acres  | 0.0086%          |

260000391

Revised Exhibit B  
 VS18  
 Docket #VGOB 23-1121-4277-01  
 List of all Owners/Claimants  
 (4,721.14 Acre Unit)

250000474

|   | Acres in Unit                      | Interest in Unit |
|---|------------------------------------|------------------|
| (k.1.2) Heather Norene Thornburg<br>1515 Town N Country Drive<br>Wilkesboro, NC 28697                 | 0.4041 acres<br>1/22 of 8.89 acres | 0.0086%          |
| <b><u>Tract #37C - 1.01 Acres</u></b>   |                                    |                  |
| (1) Commonwealth of Virginia<br>Department of Transportation<br>2111 Bonham Road<br>Bristol, VA 24201 | 1.01 acres                         | 0.0214%          |
| <b><u>Tract #37D - 0.20 Acres</u></b>   |                                    |                  |
| (1) Walter Shortt, et al  | 0.20 acres                         | 0.0042%          |
| (a) Tommy Arnold Shortt<br>PO Box 1228<br>Richlands, VA 24641   | 0.0182 acres<br>1/11 of 0.20 acres | 0.0004%          |
| (b) Walter Mervin Shortt Heirs, Deviseses,<br>Successors, or Assigns                                  |                                    |                  |
| (b.1) Mervin Shortt<br>815 W Thornwood Drive<br>South Elgin, IL 60177                                 | 0.0061 acres<br>1/33 of 0.20 acres | 0.0001%          |
| (b.2) Linda F. Grasso<br>4016 Silk Oak Lane<br>Palm Harbor, FL 34685                                  | 0.0061 acres<br>1/33 of 0.20 acres | 0.0001%          |
| (b.3) Larry Walter Shortt   | <i>pre-deceased</i>                |                  |
| (b.3.1) Larry Shortt, Jr.<br>436 Waverly Street<br>Kingsford, MI 49802                                | 0.0030 acres<br>1/66 of 0.20 acres | 0.0001%          |
| (b.3.2) Tamara Beth Ham<br>108 Chesterfield Drive<br>Pinehurst, NC 28374                              | 0.0030 acres<br>1/66 of 0.20 acres | 0.0001%          |
| (c) Harold B. Shortt Heirs, Deviseses,<br>Successors, or Assigns                                      |                                    |                  |
| (c.1) Charlene Shortt<br>PO Box 1818<br>Cedar Bluff, VA 24609   | 0.0182 acres<br>1/11 of 0.20 acres | 0.0004%          |
| (d) Glenward Jason Shortt<br>128 And Street<br>Pounding Mill, VA 24637                                | 0.0182 acres<br>1/11 of 0.20 acres | 0.0004%          |
| (e) Ballard Charlie Shortt Heirs, Deivsees,<br>Successors, or Assigns                                 |                                    |                  |
| (h.1) Earlean Shortt Heirs, Deviseses,<br>Successors, or Assigns<br><i>(Documentation Pending)</i>    | 0.0182 acres<br>1/11 of 0.20 acres | 0.0004%          |
| (h.1.1) Becky Harris<br>105 Windlass Court<br>Moneta, VA 24121  |                                    |                  |
| (f) Dorothy Short Keene<br>279 Townview Drive<br>Lebanon, VA 24266                                    | 0.0182 acres<br>1/11 of 0.20 acres | 0.0004%          |

260000391

Revised Exhibit B  
 VS18  
 Docket #VGOB 23-1121-4277-01  
 List of all Owners/Claimants  
 (4,721.14 Acre Unit)

250000474

|   | Acres in Unit                      | Interest in Unit |
|---|------------------------------------|------------------|
| (g) Maudie Short Bronson Heirs, Devisees, Successors, or Assigns  |                                    |                  |
| (g.1) Kenneth Wingo<br>1509 East Blow Road<br>Signal Mountain, TN 37377                                     | 0.0182 acres<br>1/11 of 0.20 acres | 0.0004%          |
| (h) Effie Shortt Heirs, Devisees, Successors, or Assigns  |                                    |                  |
| (h.1) Garnie Jean Thomas<br>PO Box 745<br>Doran, VA 24612   | 0.0182 acres<br>1/11 of 0.20 acres | 0.0004%          |
| (i) Garnie Jean Thomson <i>Conveyed 11/26/1997 to Harold Short and Glenward Short as JTWR0S, DB 472/104</i> |                                    |                  |
| (i.1) Harold B. Shortt <i>(DOD 1/6/2017)</i>  |                                    |                  |
| (i.2) Glenward Jason Short<br>128 And Street<br>Pounding Mill, VA 24637                                     | 0.0182 acres<br>1/11 of 0.20 acres | 0.0004%          |
| (j) Otis Herbert Shortt Heirs, Devisees, Successors, or Assigns<br><i>(Documentation Pending)</i>           | 0.0182 acres<br>1/11 of 0.20 acres | 0.0004%          |
| (k) Raymond B. Short Heirs, Devisees, Successors, or Assigns  |                                    |                  |
| (k.1) Delcie Norene Short Heirs, Devisees, Successors, or Assigns   |                                    |                  |
| (k.1.1) Grover Cleveland Elswick<br>5220 Looking Glass Trail<br>Denver, NC 28037                            | 0.0091 acres<br>1/22 of 0.20 acres | 0.0002%          |
| (k.1.2) Heather Norene Thornburg<br>1515 Town N Country Drive<br>Wilkesboro, NC 28697                       | 0.0091 acres<br>1/22 of 0.20 acres | 0.0002%          |
| <b><u>Tract #37E - 0.04 Acres</u></b>   |                                    |                  |
| (4) Walter Shortt, et al  | 0.04 acres                         | 0.0008%          |
| (a) Tommy Arnold Shortt<br>PO Box 1228<br>Richlands, VA 24641   | 0.0036 acres<br>1/11 of 0.04 acres | 0.0001%          |
| (b) Walter Mervin Shortt Heirs, Devisees, Successors, or Assigns  |                                    |                  |
| (b.1) Mervin Shortt<br>815 W Thornwood Drive<br>South Elgin, IL 60177                                       | 0.0012 acres<br>1/33 of 0.04 acres | 0.0000%          |
| (b.2) Linda F. Grasso<br>4016 Silk Oak Lane<br>Palm Harbor, FL 34685  | 0.0012 acres<br>1/33 of 0.04 acres | 0.0000%          |
| (b.3) Larry Walter Short  | <i>pre-deceased</i>                |                  |
| (b.3.1) Larry Short, Jr.<br>436 Waverly Street<br>Kingsford, MI 49802                                       | 0.0006 acres<br>1/66 of 0.04 acres | 0.0000%          |

260000391

Revised Exhibit B  
 VS18  
 Docket #VGOB 23-1121-4277-01  
 List of all Owners/Claimants  
 (4,721.14 Acre Unit)

250000474

|   | Acres in Unit                      | Interest in Unit |
|---|------------------------------------|------------------|
| (b.3.2) Tamara Beth Ham<br>108 Chesterfield Drive<br>Pinehurst, NC 28374                                      | 0.0006 acres<br>1/66 of 0.04 acres | 0.0000%          |
| (c) Harold B. Shortt Heirs, Devises,<br>Successors, or Assigns  |                                    |                  |
| (c.1) Charlene Shortt<br>PO Box 1818<br>Cedar Bluff, VA 24609   | 0.0036 acres<br>1/11 of 0.04 acres | 0.0001%          |
| (d) Glenward Jason Shortt<br>128 And Street<br>Pounding Mill, VA 24637  | 0.0036 acres<br>1/11 of 0.04 acres | 0.0001%          |
| (e) Ballard Charlie Shortt Heirs, Devises,<br>Successors, or Assigns  |                                    |                  |
| (h.1) Earlean Shortt Heirs, Devises,<br>Successors, or Assigns<br><i>(Documentation Pending)</i>              | 0.0036 acres<br>1/11 of 0.04 acres | 0.0001%          |
| (h.1.1) Becky Harris<br>105 Windlass Court<br>Moneta, VA 24121  |                                    |                  |
| (f) Dorothy Short Keene<br>279 Townview Drive<br>Lebanon, VA 24266  | 0.0036 acres<br>1/11 of 0.04 acres | 0.0001%          |
| (g) Maudie Short Bronson Heirs, Devises,<br>Successors, or Assigns  |                                    |                  |
| (g.1) Kenneth Wingo<br>1509 East Blow Road<br>Signal Mountain, TN 37377                                       | 0.0036 acres<br>1/11 of 0.04 acres | 0.0001%          |
| (h) Effie Shortt Heirs, Devises,<br>Successors, or Assigns  |                                    |                  |
| (h.1) Garnie Jean Thomas<br>PO Box 745<br>Doran, VA 24612   | 0.0036 acres<br>1/11 of 0.04 acres | 0.0001%          |
| (i) Garnie Jean Thomson <i>Conveyed 11/26/1997 to Harold Shortt and Glenward Shortt as JTWRWS, DB 472/104</i> |                                    |                  |
| (i.1) Harold B. Shortt <i>(DOD 1/6/2017)</i>  |                                    |                  |
| (i.2) Glenward Jason Shortt<br>128 And Street<br>Pounding Mill, VA 24637                                      | 0.0036 acres<br>1/11 of 0.04 acres | 0.0001%          |
| (j) Otis Herbert Shortt Heirs, Devises,<br>Successors, or Assigns<br><i>(Documentation Pending)</i>           | 0.0036 acres<br>1/11 of 0.04 acres | 0.0001%          |
| (k) Raymond B. Short Heirs, Devises,<br>Successors, or Assigns  |                                    |                  |
| (k.1) Delcie Norene Short Heirs, Devises,<br>Successors, or Assigns   |                                    |                  |
| (k.1.1) Grover Cleveland Elswick<br>5220 Looking Glass Trail<br>Denver, NC 28037                              | 0.0018 acres<br>1/22 of 0.04 acres | 0.0000%          |

260000391

Revised Exhibit B  
VS18  
Docket #VGOB 23-1121-4277-01  
List of all Owners/Claimants  
(4,721.14 Acre Unit)

250000474

|   | Acres in Unit                      | Interest in Unit |
|---|------------------------------------|------------------|
| (k.1.2) Heather Norene Thornburg<br>1515 Town N Country Drive<br>Wilkesboro, NC 28697   | 0.0018 acres<br>1/22 of 0.04 acres | 0.0000%          |
| <b><u>Tract #38 - 2.04 Acres</u></b>  |                                    |                  |
| (1) Commonwealth Coal Corporation<br>PO Box 1269<br>Bristol, VA 24203   | 2.04 acres                         | 0.0432%          |
| <b><u>Tract #39 - 2.65 Acres</u></b>  |                                    |                  |
| (1) Commonwealth Coal Corporation<br>PO Box 1269<br>Bristol, VA 24203   | 2.65 acres                         | 0.0561%          |
| <b><u>Tract #40A - 212.51 Acres</u></b>   |                                    |                  |
| (1) Commonwealth Coal Corporation<br>PO Box 1269<br>Bristol, VA 24203   | 212.51 acres                       | 4.5012%          |
| <b><u>Tract #40B - 0.49 Acres</u></b>   |                                    |                  |
| (1) Commonwealth Coal Corporation<br>PO Box 1269<br>Bristol, VA 24203   | 0.49 acres                         | 0.0104%          |
| <b><u>Tract #41A - 43.66 Acres</u></b>  |                                    |                  |
| (1) Gary Addison, et al   |                                    |                  |
| (a) Doris Addison<br>1305 Terrace Court<br>Sykesville, MD 21784   | 43.66 acres                        | 0.9248%          |
|   | <i>Life Estate</i>                 |                  |
| <i>By Instrument #230000095 Gary Curtis Addison, Warren Drew Addison, Lucinda Margaret Wasserman, and Anna Marie Hooper (Assignors) assign all right to royalties due to Assignors to Doris Betty Addison as Assignee for and during her natural life</i>   |                                    |                  |
| <i>By Instrument #230000096 Doris Betty Addison (hereinafter called Life Tenant) and Gary Curtis Addison, Warren Drew Addison, Lucinda Margaret Wasserman, and Anna Marie Hooper (Grantors) and Doris Betty Addison (hereinafter called Life Tenant) executed a Deed of Correction for the purpose of clarifying the intent of the parties to Instrument 090001401 was to grant and convey unto the Life Tenant all minerals together with all rents and royalties generated by the same, and further grant and convey unto the Remainderman as joint tenants with rights of survivorship a remainder interest in the properties together with the right with the Life Tenant to receive equal portions of any monies paid as reimbursement for damages to said property.</i> |                                    |                  |
| (b) Gary Addison<br>1305 Terrace Court<br>Sykesville, MD 21784  |                                    |                  |
| (c) Warren Addison<br>1305 Terrace Court<br>Sykesville, MD 21784  |                                    |                  |
| (d) Anna Marie Hooper<br>2219 Sykesville Rd #2<br>Westminster, MD 21157   |                                    |                  |
| (e) Lucinda Wasserman<br>3801 Rinehart Road<br>Westminster, MD 21158  |                                    |                  |
| <b><u>Tract #41B - 23.97 Acres</u></b>  |                                    |                  |
| (1) Curtis Elster Wade Heirs  | 23.97 acres                        | 0.5077%          |
| (a) Laura B. Wade Heirs, Devisees,<br>Successors, or Assigns  |                                    |                  |

260000391

Revised Exhibit B  
 VS18  
 Docket #VGOB 23-1121-4277-01  
 List of all Owners/Claimants  
 (4,721.14 Acre Unit)

250000474

|   | Acres in Unit                      | Interest in Unit |
|---|------------------------------------|------------------|
| (a.1) Curtis R. Wade<br>926 High Point Drive<br>Mount Dora, FL 32757      | 3.4243 acres<br>1/7 of 23.97 acres | 0.0725%          |
| (a.2) Barbara W. Hendrix<br>127 W Meldody Drive<br>Jesup, GA 31545        | 3.4243 acres<br>1/7 of 23.97 acres | 0.0725%          |
| (a.3) Susan J. Wade<br>6745 N Richmond Street<br>Chicago, IL 60645        | 3.4243 acres<br>1/7 of 23.97 acres | 0.0725%          |
| (a.4) Lydia R. Freund<br>734 Norton Avenue<br>Mundelein, IL 60060         | 3.4243 acres<br>1/7 of 23.97 acres | 0.0725%          |
| (a.5) Thelma Josie Wade<br>16330 Old Timber Road<br>Abingdon, VA 24210    | 3.4243 acres<br>1/7 of 23.97 acres | 0.0725%          |
| (a.6) Julia W. Beckham<br>12500 Virtudes Street<br>Coral Gables, FL 33156 | 3.4243 acres<br>1/7 of 23.97 acres | 0.0725%          |
| (a.7) Nathan Wade<br>113 Hillrose Avenue<br>Greenville, SC 29609          | 3.4243 acres<br>1/7 of 23.97 acres | 0.0725%          |
| <b><u>Tract #41C - 10.72 Acres</u></b>                                    |                                    |                  |
| (1) Gerald K. Shortt<br>1475 Shortts Road<br>Raven, VA 24639              | 10.72 acres                        | 0.2271%          |
| <b><u>Tract #41D - 3.41 Acres</u></b>                                     |                                    |                  |
| (1) Rondal & Freda Wade, TE<br>1053 Short Hill Road<br>Raven, VA 24639    | 3.41 acres                         | 0.0722%          |
| <b><u>Tract #41E - 1.72 Acres</u></b>                                     |                                    |                  |
| (1) Jimmy & Linda Wade, TE<br>1333 Short Hill Road<br>Raven, VA 24639     | 1.72 acres                         | 0.0364%          |
| <b><u>Tract #41F - 1.66 Acres</u></b>                                     |                                    |                  |
| (1) Evelyn Sprinkle Brown Heirs, Devises,<br>Successors, or Assigns       | 1.66 acres                         | 0.0352%          |
| (a) Dianne Creed<br>18593 Ironwood Loop<br>Abingdon, VA 24210             | 0.5533 acres<br>1/3 of 1.66 acres  | 0.0117%          |
| (b) William Richard Brown<br>1907 Riverside Drive<br>Raven, VA 24639      | 0.5533 acres<br>1/3 of 1.66 acres  | 0.0117%          |
| (c) Dorothy Wallace<br>410 First Street<br>Spencer, NC 28159              | 0.5533 acres<br>1/3 of 1.66 acres  | 0.0117%          |

260000391

Revised Exhibit B  
VS18  
Docket #VGOB 23-1121-4277-01  
List of all Owners/Claimants  
(4,721.14 Acre Unit)

250000474

|   | Acres in Unit | Interest in Unit |
|---|---------------|------------------|
| <b><u>Tract #41G - 0.25 Acres</u></b>   |               |                  |
| (1) Commonwealth of Virginia<br>Department of Transportation<br>2111 Bonham Road<br>Bristol, VA 24201 | 0.25 acres    | 0.0053%          |
| <b><u>Tract #41H - 1.45 Acres</u></b>   |               |                  |
| (1) Elmer & Elsie Burke, TE<br>1759 Riverside Dr<br>Raven, VA 24639                                   | 1.45 acres    | 0.0307%          |
| <b><u>Tract #42 - 301.84 Acres</u></b>  |               |                  |
| (1) Commonwealth Coal Corporation<br>PO Box 1269<br>Bristol, VA 24203                                 | 301.84 acres  | 6.3934%          |
| <b><u>Tract #43 - 125.72 Acres</u></b>  |               |                  |
| (1) Coal Mountain Mining Company LLP<br>P.O. Box 675<br>Tazewell, VA 24651                            | 125.72 acres  | 2.6629%          |
| <b><u>Tract #44 - 882.64 Acres</u></b>  |               |                  |
| (1) Commonwealth Coal Corporation<br>PO Box 1269<br>Bristol, VA 24203                                 | 882.64 acres  | 18.6955%         |
| <b><u>Tract #45 - 623.54 Acres</u></b>  |               |                  |
| (1) Coal Mountain Mining Company LLP<br>P.O. Box 675<br>Tazewell, VA 24651                            | 623.54 acres  | 13.2074%         |

Exhibit B2  
 VS18 - Revised Unit  
 Docket #VGOB 23-1121-4277-01  
 List of Respondents/Tracts to be Dismissed  
 (4,721.14 Acre Unit - Revised Acres)

|   | (Based on Original Acres)                            |                  | Reason for Dismissal                                   |
|---|--|------------------|--|
|   | Acres in Unit  | Interest in Unit |  |
| <b>II. OIL &amp; GAS OWNERSHIP</b>  |  |                  |  |
| <b><u>Tract #2 - 15.14 Acres</u></b>  |  |                  |  |
| (f) Gary Davis, et al   | 15.14 acres  | 0.3016%          | <b>Transferred to Buch No. 1<br/>South 1 Panel SGU</b> |
| (a) Gary Davis<br>1189 Point Road<br>Raven, VA 24639  | 6.056 acres<br>2/5 of 15.14 acres                    | 0.1206%          |  |
| (b) Larry Wayne Davis<br>PO Box 183<br>Pounding Mill, VA 24637                                | 3.028 acres<br>1/5 of 15.14 acres                    | 0.0603%          |  |
| (c) Buford R. Davis   | <i>Conveyed January 9, 2020, Instrument# 20-0023</i> |                  |  |
| (c.1) Ricky Davis<br>532 Indian Hills Drive<br>Cedar Bluff, VA 24609                          | 3.028 acres<br>1/5 of 15.14 acres                    | 0.0603%          |  |
| (d) Ruth M. Boyd Heirs, Devisees, Successors,<br>or Assigns<br><i>(Documentation Pending)</i> | 3.028 acres<br>1/5 of 13.18 acres                    | 0.0603%          |  |
| (d.1) Gwenda Ligett<br>402 North Marshall Road<br>Middletown, OH 45042                        |  |                  |  |
| (d.2) Wanda Zahn<br>138 Sweet Briar Drive<br>Batavia, OH 45103                                |  |                  |  |
| (d.3) Candace Sue McCroy<br>3236 N Talbot Ave, Apt 3<br>Erlanger, KY 41018                    |  |                  |  |
| <b><u>Tract #3 - 1.67 Acres</u></b>   |  |                  |  |
| (f) Gary Davis, et al   | 1.67 acres   | 0.0333%          | <b>Transferred to Buch No. 1<br/>South 1 Panel SGU</b> |
| (a) Gary C. Davis<br>1189 Point Road<br>Raven, VA 24639                                       | 0.223 acres<br>2/15 of 1.67 acres                    | 0.0044%          |  |
| (b) Patsy Davis Heirs, Devisees, Successors, or Assigns                                       |  |                  |  |
| (b.1) Gary C. Davis<br>1189 Point Road<br>Raven, VA 24639                                     | 0.223 acres<br>2/15 of 1.67 acres                    | 0.0044%          |  |
| (c) Larry Wayne Davis<br>PO Box 183<br>Pounding Mill, VA 24637                                | 0.223 acres<br>2/15 of 1.67 acres                    | 0.0044%          |  |
| (d) Buford R. Davis   | <i>Conveyed January 9, 2020, Instrument# 20-0023</i> |                  |  |
| (d.1) Ricky Davis<br>532 Indian Hills Drive<br>Cedar Bluff, VA 24609                          | 0.223 acres<br>2/15 of 1.67 acres                    | 0.0044%          |  |
| (e) Jacqueline Davis<br>PO Box 183<br>Pounding Mill, VA 24637                                 | 0.223 acres<br>2/15 of 1.67 acres                    | 0.0044%          |  |

260000391

250000474

Exhibit B2  
 VS18 - Revised Unit  
 Docket #VGOB 23-1121-4277-01  
 List of Respondents/Tracts to be Dismissed  
 (4,721.14 Acre Unit - Revised Acres)

|   | Acres in Unit                     | (Based on Original Acres) |  | Reason for Dismissal                                   |
|---|-----------------------------------|---------------------------|--|--|
|   |                                   | Interest in Unit          |  |  |
| (f) Doris Davis<br>827 Green Acres Street<br>Pounding Mill, VA 24637  | 0.223 acres<br>2/15 of 1.67 acres | 0.0044%                   |  |  |
| (g) Ruth M. Boyd Heirs, devisees, Successors,<br>or Assigns<br><i>(Documentation Pending)</i>   | 0.334 acres<br>1/5 of 1.67 acres  | 0.0067%                   |  |  |
| (g.1) Gwenda Ligett<br>402 North Marshall Road<br>Middletown, OH 45042  |                                   |                           |  |  |
| (g.2) Wanda Zahn<br>138 Sweet Briar Drive<br>Batavia, OH 45103  |                                   |                           |  |  |
| (g.3) Candace Sue McCroy<br>3236 N Talbot Ave, Apt 3<br>Erlanger, KY 41018  |                                   |                           |  |  |
| <b><u>Tract #6 - 0.88 Acres</u></b>   |                                   |                           |  |  |
| <i>Note: CBM ownership was adjudicated to the prevailing plaintiffs under Case no. CL 11-0497-00<br/>The Corrected Final Order was executed September 29, 2011 and plaintiffs were awarded 100% of the<br/>Coalbed Methane Gas underlying this tract.</i> |                                   |                           |  |  |
| (1) Loya Edgar Davis Compton Heirs, devisees,<br>Successors or Assigns<br><i>(6 Acre Tract)</i>   | 0.88 acres                        | 0.0175%                   |  | <b>Transferred to Buch No. 1<br/>South 1 Panel SGU</b> |
| (a) Allie I. Davis Clowers<br>150 County Road 161<br>Riceville, TN 37370  | 0.11 acres<br>1/8 of 0.88 acres   | 0.0022%                   |  |  |
| (b) Buford Davis Heirs, devisees,<br>Successors, or Assigns   |                                   |                           |  |  |
| (b.1) Doris Davis<br>827 Green Acres Street<br>Pounding Mill, VA 24637  | 0.11 acres<br>1/8 of 0.88 acres   | 0.0022%                   |  |  |
| (c) Billy D. Davis Heirs, devisees,<br>Successors or Assigns  |                                   |                           |  |  |
| (c.1) Billy Michael Davis<br>1839 W. Market Street<br>Smithfield, NC 27577  | 0.06 acres<br>1/16 of 0.88 acres  | 0.0011%                   |  |  |
| (c.2) Lisa Diane Davis<br>1839 W. Market Street<br>Smithfield, NC 27577   | 0.06 acres<br>1/16 of 0.88 acres  | 0.0011%                   |  |  |
| (d) Joe Darrell Davis<br>1752 Sandy Gap Rd.<br>Raven, VA 24639  | 0.11 acres<br>1/8 of 0.88 acres   | 0.0022%                   |  |  |
| (e) Bobby Davis<br>101 Able Road<br>Cedar Bluff, VA 24609   | 0.11 acres<br>1/8 of 0.88 acres   | 0.0022%                   |  |  |
| (f) Gary Davis<br>1189 Point Road<br>Raven, VA 24639  | 0.11 acres<br>1/8 of 0.88 acres   | 0.0022%                   |  |  |

260000391

250000474

Exhibit B2  
 VS18 - Revised Unit  
 Docket #VGOB 23-1121-4277-01  
 List of Respondents/Tracts to be Dismissed  
 (4,721.14 Acre Unit - Revised Acres)

|  | (Based on Original Acres)       |                  |  |
|--|---------------------------------|------------------|--|
|  | Acres in Unit                   | Interest in Unit | Reason for Dismissal                                   |
| (g) Larry Wayne Davis<br>PO Box 183<br>Pounding Mill, VA 24637   | 0.11 acres<br>1/8 of 0.88 acres | 0.0022%          |  |
| (h) Jimmy A. Davis Heirs, Devisees, Successors or Assigns  |                                 |                  |  |
| (h.1) Dorothy Davis, Sandy Barnette, Mark Davis, and Jimmy Davis, Jr.<br><i>Conveyed to (h.2) as tenants in entirety with right of survivorship. Instrument# 100001037 dated 4/20/2010</i> |                                 |                  |  |
| (h.2) Larry Wayne & Jackie Davis, TE<br>PO Box 183<br>Pounding Mill, VA 24637  | 0.11 acres<br>1/8 of 0.88 acres | 0.0022%          |  |
| <b><u>Tract #9 - 4.10 Acres</u></b>  |                                 |                  |  |
| (1) Coal Mountain Mining Company LLP<br>P.O. Box 675<br>Tazewell, VA 24651   | 4.10 acres                      | 0.0817%          | <b>Transferred to Buch No. 1<br/>South 1 Panel SGU</b> |
| <b><u>Tract #23 - 7.12 Acres</u></b>   |                                 |                  |  |
| (1) Pocahontas Gas LLC, et al<br><i>(47.90 Acre Tract)</i>   | 7.12 acres                      | 0.1418%          |  |
| (b) Ruie McGlothlin Heirs, Devisees,<br>Successors, or Assigns   |                                 |                  |  |
| (b.3) Ruby Lee Zwald Heirs, Devisees,<br>Successors, or Assigns  |                                 |                  |  |
| (b.3.1) Walter Lawrence Finney Heirs,<br>Devisees, Successors, or Assigns  |                                 |                  |  |
| (b.3.1.1) Shelby Ann Finney  |                                 |                  | <b>Deeded Interest</b>                                 |
| <b><u>Tract #33A - 26.89 Acres</u></b>   |                                 |                  |  |
| (1) Pocahontas Gas LLC, et al<br><i>(37.00 Acre Tract)</i>   | 26.89 acres                     | 0.5357%          |  |
| (b.3) Ruby Lee Zwald Heirs, Devisees,<br>Successors, or Assigns  |                                 |                  |  |
| (b.3.1) Walter Lawrence Finney Heirs,<br>Devisees, Successors, or Assigns  |                                 |                  |  |
| (b.3.1.1) Shelby Ann Finney  |                                 |                  | <b>Deeded Interest</b>                                 |

260000391

Exhibit B3  
VS18  
Docket #VGOB 23-1121-4277-01  
List of all unleased Owners/Claimants  
(4,721.14 Acre Unit)

250000474

|  | Acres in Unit                     | Interest in Unit |
|--|-----------------------------------|------------------|
| <b>II. OIL &amp; GAS OWNERSHIP</b>   |                                   |                  |
| <u>Tract #2 - Transferred to Buch No 1 South 1 Panel SGU</u>   |                                   |                  |
| <u>Tract #3 - Transferred to Buch No 1 South 1 Panel SGU</u>   |                                   |                  |
| <u>Tract #6 - Transferred to Buch No 1 South 1 Panel SGU</u>   |                                   |                  |
| <u>Tract #7 - 17.47 Acres</u>  |                                   |                  |
| <i>Note: CBM ownership was adjudicated to the prevailing plaintiffs under Case no. CL 11-0497-00. The Corrected Final Order was executed September 29, 2011 and plaintiffs were awarded 100% of the Coalbed Methane Gas underlying this tract.</i> |                                   |                  |
| (1) Loya Edgar Davis Compton Heirs, Deviseses, Successors or Assigns<br><i>(71.75 acre tract)</i>  | 17.47 acres                       | 0.3700%          |
| (a) Allie Davis Clowers<br>150 County Road 161<br>Riceville, TN 37370  | 2.18 acres<br>1/8 of 17.47 acres  | 0.0463%          |
| (b) Buford Davis Heirs, Deviseses, Successors, or Assigns  |                                   |                  |
| (b.1) Doris Davis<br>827 Green Acres Street<br>Pounding Mill, VA 24637   | 2.18 acres<br>1/8 of 17.47 acres  | 0.0463%          |
| (c) Billy D. Davis Heirs, Deviseses, Successors or Assigns   |                                   |                  |
| (c.1) Billy Michael Davis<br>1839 W. Market Street<br>Smithfield, NC 27577   | 1.09 acres<br>1/16 of 17.47 acres | 0.0231%          |
| (c.2) Lisa Diane Davis<br>1839 W Market Street<br>Smithfield, NC 27577   | 1.09 acres<br>1/16 of 17.47 acres | 0.0231%          |
| (d) Joe Darrell Davis<br>1752 Sandy Gap Rd.<br>Raven, VA 24639   | 2.18 acres<br>1/8 of 17.47 acres  | 0.0463%          |
| (e) Bobby Davis<br>101 Able Road<br>Cedar Bluff, VA 24609  | 2.18 acres<br>1/8 of 17.47 acres  | 0.0463%          |
| (f) Gary Davis<br>1189 Point Road<br>Raven, VA 24639   | 2.18 acres<br>1/8 of 17.47 acres  | 0.0463%          |
| (g) Larry Wayne Davis<br>PO Box 183<br>Pounding Mill, VA 24637   | 2.18 acres<br>1/8 of 17.47 acres  | 0.0463%          |
| (h) Jimmy A. Davis Heirs, Deviseses, Successors or Assigns   |                                   |                  |
| (h.1) Dorothy Davis, Sandy Barnette, Mark Davis, and Jimmy Davis, Jr.<br><i>Conveyed to (h.2) as tenants in entirety with right of survivorship. Instrument# 100001037 dated 4/20/2010</i>   |                                   |                  |

Exhibit B3  
VS18  
Docket #VGOB 23-1121-4277-01  
List of all unleased Owners/Claimants  
(4,721.14 Acre Unit)

250000474

|   | Acres in Unit                     | Interest in Unit |
|---|-----------------------------------|------------------|
| (h.2) Larry Wayne and Jacqueline Davis, TE<br>PO Box 183<br>Pounding Mill, VA 24637   | 2.18 acres<br>1/8 of 17.47 acres  | 0.0463%          |
| Total Tract Acres 17.47<br>Total Tract Percentage 0.3700%   |                                   |                  |
| <b><u>Tract #15 - 3.01 Acres</u></b>  |                                   |                  |
| (1) Commonwealth of Virginia<br>Department of Highways<br>2111 Bonham Road<br>Bristol, VA 24201   | 3.01 acres                        | 0.0638%          |
| <b><u>Tract #20 - 2.07 Acres</u></b>  |                                   |                  |
| (1) Thomas P. Stilwell<br>1898 Old Kentucky Turnpike Road<br>Raven, VA 24639  | 2.07 acres                        | 0.0438%          |
| <b><u>Tract #23 - 7.12 Acres</u></b>  |                                   |                  |
| (1) Pocahontas Gas LLC, et al<br><i>(47.90 Acre Tract)</i>  | 7.12 acres                        | 0.1508%          |
| (b) Ruie McGlothlin Heirs, Devisees,<br>Successors, or Assigns  |                                   |                  |
| (b.1) Junior C. McGlothlin Heirs, Devisees,<br>Successors, or Assigns   |                                   |                  |
| (b.1.1) Janet E. McGlothlin Heirs, Devisees,<br>Successors, or Assigns  |                                   |                  |
| (b.1.1.1) Johnny Dwight McGlothlin<br>820 Baptist Valley Road<br>Cedar Bluff, VA 24609  | 0.01 acres<br>1/672 of 7.12 acres | 0.0002%          |
| (b.2) Helen Adams Heirs, Devisees,<br>Successors, or Assigns<br><i>(Documentation Pending)</i>  | 0.03 acres<br>1/224 of 7.12 acres | 0.0007%          |
| (b.2.1) Bernie Gene Adams<br>14309 Phoenix Road<br>Phoenix, MD 21131  |                                   |                  |
| (b.2.2) Michael Adams<br>220 E Lakeview Street<br>Umatilla, FL 32784  |                                   |                  |
| (b.3) Ruby Lee Zwald Heirs, Devisees,<br>Successors, or Assigns   |                                   |                  |
| (b.3.1) Walter Lawrence Finney Heirs,<br>Devisees, Successors, or Assigns   |                                   |                  |
| (b.3.1.1) Shelby Ann Finney<br><i>Conveyed to Cheryl Keen Tucker and Bernie Gene Adams as tenants in common. RC - Instr# 220001375, BC - Instr# 2200000738,<br/>TC - Instr# 220001829, all dated 6/6/2022</i> |                                   |                  |
| (b.3.1.1.1) Cheryl Keen Tucker<br>170 Charleston Place<br>Daleville, VA 24083   | 0.02 acres<br>1/448 of 7.12 acres | 0.0003%          |
| (b.3.1.1.2) Bernie Gene Adams<br>14309 Phoenix Road<br>Phoenix, MD 21131  | 0.02 acres<br>1/448 of 7.12 acres | 0.0003%          |

260000391

Exhibit B3  
VS18  
Docket #VGOB 23-1121-4277-01  
List of all unleased Owners/Claimants  
(4,721.14 Acre Unit)

250000474

|   | Acres in Unit                     | Interest in Unit |
|---|-----------------------------------|------------------|
| (b.4) Mary R. Barnett Heirs, Deviseses, Successors, or Assigns  |                                   |                  |
| (b.4.1) Cheryl Keen Tucker<br>170 Charleston Place<br>Daleville, VA 24083                             | 0.03 acres<br>1/224 of 7.12 acres | 0.0007%          |
| Total Tract Acres 0.11<br>Total Tract Percentage 0.0022%  |                                   |                  |
| <b><u>Tract #29A - 5.59 Acres</u></b>   |                                   |                  |
| (1) Janice L. & Jeremy W. Davis, TE<br>1011 Betsy Branch Road<br>Raven, VA 24639                      | 5.59 acres                        | 0.1184%          |
| <b><u>Tract #29B - 3.74 Acres</u></b>   |                                   |                  |
| (1) William & Hannalore Engardio, T/E<br>3187 Riverside Drive<br>Raven, VA 24639                      | 3.74 acres                        | 0.0792%          |
| <b><u>Tract #29D - 1.24 Acres</u></b>   |                                   |                  |
| (1) Danny Wayne Hinkle<br>PO Box 571<br>Oakwood, VA 24631   | 1.24 acres                        | 0.0263%          |
| <b><u>Tract #29E - 9.87 Acres</u></b>   |                                   |                  |
| (1) Commonwealth of Virginia<br>Department of Transportation<br>2111 Bonham Road<br>Bristol, VA 24201 | 9.87 acres                        | 0.2091%          |
| <b><u>Tract #29F - 3.97 Acres</u></b>   |                                   |                  |
| (1) Russell V. and Anita Presley, TE<br>PO Box 463<br>Keen Mountain, VA 24624                         | 3.97 acres                        | 0.0841%          |
| <b><u>Tract #29G - 0.08 Acres</u></b>   |                                   |                  |
| (1) Jadco, Inc.<br>3081 Riverside Drive<br>Raven, VA 24639  | 0.08 acres                        | 0.0017%          |
| <b><u>Tract #29H - 0.61 Acres</u></b>   |                                   |                  |
| (1) Jadco, Inc.<br>3081 Riverside Drive<br>Raven, VA 24639  | 0.61 acres                        | 0.0129%          |
| <b><u>Tract #29I - 0.23 Acres</u></b>   |                                   |                  |
| (1) Jadco, Inc.<br>3081 Riverside Drive<br>Raven, VA 24639  | 0.23 acres                        | 0.0049%          |
| <b><u>Tract #29L - 1.16 Acres</u></b>   |                                   |                  |
| (1) Joel D. & Brenda L. Burke<br>PO Box 33<br>Rowe, VA 24646  | 1.16 acres                        | 0.0246%          |

260000391

250000474

Exhibit B3  
 VS18  
 Docket #VGOB 23-1121-4277-01  
 List of all unleased Owners/Claimants  
 (4,721.14 Acre Unit)

|   | Acres in Unit                     | Interest in Unit |
|---|-----------------------------------|------------------|
| <b><u>Tract #29O - 1.98 Acres</u></b>   |                                   |                  |
| (1) Commonwealth of Virginia<br>Department of Transportation<br>2111 Bonham Road<br>Bristol, VA 24201 | 1.98 acres                        | 0.0419%          |
| <b><u>Tract #29R - 0.50 Acres</u></b>   |                                   |                  |
| (1) Commonwealth of Virginia<br>Department of Transportation<br>2111 Bonham Road<br>Bristol, VA 24201 | 0.50 acres                        | 0.0106%          |
| <b><u>Tract #29S - 0.68 Acres</u></b>   |                                   |                  |
| (1) Commonwealth of Virginia<br>Department of Transportation<br>2111 Bonham Road<br>Bristol, VA 24201 | 0.68 acres                        | 0.0144%          |
| <b><u>Tract #29U - 3.39 Acres</u></b>   |                                   |                  |
| (1) Patrick Counts<br>1665 Riverside Drive<br>Raven, VA 24639   | 3.39 acres                        | 0.0718%          |
| <b><u>Tract #29W - 0.90 Acres</u></b>   |                                   |                  |
| (1) Grady W. & Pauline J. McGlothlin<br>PO Box 955<br>Raven, VA 24639                                 | 0.90 acres                        | 0.0191%          |
| <b><u>Tract #29X - 1.10 Acres</u></b>   |                                   |                  |
| (1) Commonwealth of Virginia<br>Department of Transportation<br>2111 Bonham Road<br>Bristol, VA 24201 | 1.10 acres                        | 0.0233%          |
| <b><u>Tract #29Y - 0.89 Acres</u></b>   |                                   |                  |
| (1) Oris Cantrell Heirs, Devises,<br>Successors, or Assigns   | 0.89 acres                        | 0.0189%          |
| (a) Amy Mae Hess<br>PO Box 922<br>Vansant, VA 24656   | 0.2225 acres<br>1/4 of 0.89 acres | 0.0047%          |
| (b) Jamie Cantrell<br>282 Westview Street<br>Pounding Mill, VA 24637                                  | 0.2225 acres<br>1/4 of 0.89 acres | 0.0047%          |
| (c) Penny Falck<br>2390 Glade Drive<br>Christiansburg, VA 24073                                       | 0.2225 acres<br>1/4 of 0.89 acres | 0.0047%          |
| (d) Cathleen Arrington<br>7342 Pine Street<br>Radford, VA 24141                                       | 0.2225 acres<br>1/4 of 0.89 acres | 0.0047%          |

Total Tract Acres 0.89  
 Total Tract Percentage 0.0189%

260000391

250000474

Exhibit B3  
VS18  
Docket #VGOB 23-1121-4277-01  
List of all unleased Owners/Claimants  
(4,721.14 Acre Unit)

|   | Acres in Unit                       | Interest in Unit |
|---|-------------------------------------|------------------|
| <b><u>Tract #33A - 26.89 Acres</u></b>  |                                     |                  |
| (1) Pocahontas Gas LLC, et al<br><i>(37.00 Acre Tract)</i>  | 26.89 acres                         | 0.5696%          |
| (b) Ruie McGlothlin Heirs, Devisees,<br>Successors, or Assigns  |                                     |                  |
| (b.1) Junior C. McGlothlin Heirs, Devisees,<br>Successors, or Assigns   |                                     |                  |
| (b.1.1) Janet E. McGlothlin Heirs, Devisees,<br>Successors, or Assigns  |                                     |                  |
| (b.1.1.1) Johnny Dwight McGlothlin<br>820 Baptist Valley Road<br>Cedar Bluff, VA 24609  | 0.040 acres<br>1/672 of 26.89 acres | 0.0008%          |
| (b.2) Helen Adams Heirs, Devisees,<br>Successors, or Assigns<br><i>(Documentation Pending)</i>  | 0.120 acres<br>1/224 of 26.89 acres | 0.0025%          |
| (b.2.1) Bernie Gene Adams<br>14309 Phoenix Road<br>Phoenix, MD 21131  |                                     |                  |
| (b.2.2) Michael Adams<br>220 E Lakeview Street<br>Umatilla, FL 32784  |                                     |                  |
| (b.3) Ruby Lee Zwald Heirs, Devisees,<br>Successors, or Assigns   |                                     |                  |
| (b.3.1) Walter Lawrence Finney Heirs,<br>Devisees, Successors, or Assigns   |                                     |                  |
| (b.3.1.1) Shelby Ann Finney<br><i>Conveyed to Cheryl Keen Tucker and Bernie Gene Adams as tenants in common, RC - Instr# 220001375, BC - Instr# 2200000738,<br/>TC - Instr# 220001829, all dated 6/6/2022</i> |                                     |                  |
| (b.3.1.1.1) Cheryl Keen Tucker<br>170 Charleston Place<br>Daleville, VA 24083   | 0.060 acres<br>1/448 of 26.89 acres | 0.0013%          |
| (b.3.1.1.2) Bernie Gene Adams<br>14309 Phoenix Road<br>Phoenix, MD 21131  | 0.060 acres<br>1/448 of 26.89 acres | 0.0013%          |
| (b.4) Mary R. Barnett Heirs, Devisees,<br>Successors, or Assigns  |                                     |                  |
| (b.4.1) Cheryl Keen Tucker<br>170 Charleston Place<br>Daleville, VA 24083   | 0.120 acres<br>1/224 of 26.89 acres | 0.0025%          |
| Total Tract Acres 0.40<br>Total Tract Percentage 0.0085%  |                                     |                  |
| <b><u>Tract #33B - 2.31 Acres</u></b>   |                                     |                  |
| (1) Commonwealth of Virginia<br>Department of Transportation<br>2111 Bonham Road<br>Bristol, VA 24201   | 2.31 acres                          | 0.0489%          |

260000391

Exhibit B3  
 VS18  
 Docket #VGOB 23-1121-4277-01  
 List of all unleased Owners/Claimants  
 (4,721.14 Acre Unit)

250000474

|   | Acres in Unit                      | Interest in Unit |
|---|------------------------------------|------------------|
| <b><u>Tract #33C - 1.62 Acres</u></b>   |                                    |                  |
| (1) Jimmy Lee McGlothlin<br>PO Box 987<br>Raven, VA 24639   | 1.62 acres                         | 0.0343%          |
| <b><u>Tract #36A - 19.31 Acres</u></b>  |                                    |                  |
| (1) Bernard Shortt, et al   | 19.31 acres                        | 0.4090%          |
| (a) Roy Bernard and Linda Ruth Shortt<br>642 Shortts Road<br>Raven, VA 24639  | <i>Life Estate</i>                 |                  |
| (b) Joshua Andrew Shortt* (DOD 8/25/2021)   |                                    |                  |
| (c) Barney Andrew Shortt*<br>728 Shortts Road<br>Raven, VA 24639  | 9.655 acres<br>1/2 of 19.31 acres  | 0.2045%          |
| (d) Janet Shortt*<br>728 Shortts Road<br>Raven, VA 24639  | 9.655 acres<br>1/2 of 19.31 acres  | 0.2045%          |
| <i>*Joshua Andrew Shortt, Barney Andrew Shortt, and Janet Shortt were conveyed ownership as joint tenants with right of survivorship</i>  |                                    |                  |
| Total Tract Acres 19.31<br>Total Tract Percentage 0.4090%   |                                    |                  |
| <b><u>Tract #36B - 0.19 Acres</u></b>   |                                    |                  |
| (1) Barney Shortt, et al  |                                    |                  |
| (a) Roy Bernard and Linda Ruth Shortt<br>642 Shortts Road<br>Raven, VA 24639  | <i>Life Estate</i>                 |                  |
| (b) Barney Andrew and Janet Shortt**<br>728 Shortts Road<br>Raven, VA 24639   | 0.19 acres                         | 0.0040%          |
| <i>**Tenants in entirety with right of survivorship</i>   |                                    |                  |
| <b><u>Tract #36C - 0.42 Acres</u></b>   |                                    |                  |
| <i>***Cloud on Title - When Tom Shortt acquired title to the parent tract of which this property is a portion, he also obtained title to the gas and oil. He then conveyed the property to his wife (Bertha) and reserved all minerals in DB 190/119. Bertha later conveyed back to Tom in DB 217/438, with the same reservation language, though she owned no mineral to reserve. Tom again conveyed to Bertha in DB 281/12, reserving all mineral. Bertha again conveyed to Tom in DB 331/248, and again reserved mineral she did not own. Tom Shortt and Bertha Shortt conveyed to Walter M. Shortt and Jeanette H. Shortt in DB 342/400, a 3.2 acre parcel, referencing as the source of title DB 331/248 wherein Bertha reserved mineral she did not own, as the mineral reservation language. The intent of Bertha and Tom Shortt may have been to reserve all mineral, however, the source reservation language reference within DB 342/400 fails. Correction deeds are necessary to vest title to the oil and gas in either the heirs of Tom Shortt, or the current surface owners. Robert and Jackie Rose.</i> |                                    |                  |
| (1) Walter Shortt, et al  | 0.42 acres                         | 0.0089%          |
| (a) Tommy Arnold Shortt<br>PO Box 1228<br>Richlands, VA 24641   | 0.0382 acres<br>1/11 of 0.42 acres | 0.0008%          |
| (b) Walter Mervin Shortt Heirs, Devisees,<br>Successors, or Assigns   |                                    |                  |
| (b.1) Mervin Shortt<br>815 W Thornwood Drive<br>South Elgin, IL 60177   | 0.0127 acres<br>1/33 of 0.42 acres | 0.0003%          |

260000391  
250000474

Exhibit B3  
VS18  
Docket #VGOB 23-1121-4277-01  
List of all unleased Owners/Claimants  
(4,721.14 Acre Unit)

|  | Acres in Unit   | Interest in Unit |
|--|---|------------------|
| (b.2) Linda F. Grasso<br>4016 Silk Oak Lane<br>Palm Harbor, FL 34685                             | 0.0127 acres<br>1/33 of 0.42 acres  | 0.0003%          |
| (b.3) Larry Walter Short   | <i>pro-deceased</i>   |                  |
| (b.3.1) Larry Short, Jr.<br>436 Waverly Street<br>Kingsford, MI 49802                            | 0.0064 acres<br>1/66 of 0.42 acres  | 0.0001%          |
| (b.3.2) Tamara Beth Ham<br>108 Chesterfield Drive<br>Pinehurst, NC 28374                         | 0.0064 acres<br>1/66 of 0.42 acres  | 0.0001%          |
| (c) Harold B. Shortt Heirs, Devises, Successors, or Assigns                                      |   |                  |
| (c.1) Charlene Shortt<br>PO Box 1818<br>Cedar Bluff, VA 24609                                    | 0.0382 acres<br>1/11 of 0.42 acres  | 0.0008%          |
| (d) Glenward Jason Shortt<br>128 And Street<br>Pounding Mill, VA 24637                           | 0.0382 acres<br>1/11 of 0.42 acres  | 0.0008%          |
| (e) Ballard Charlie Shortt Heirs, Deivsees, Successors, or Assigns                               |   |                  |
| (h.1) Earlean Shortt Heirs, Devises, Successors, or Assigns<br><i>(Documentation Pending)</i>    | 0.0382 acres<br>1/11 of 0.42 acres  | 0.0008%          |
| (h.1.1) Becky Harris<br>105 Windlass Court<br>Moneta, VA 24121                                   |   |                  |
| (f) Dorothy Short Keene<br>279 Townview Drive<br>Lebanon, VA 24266                               | 0.0382 acres<br>1/11 of 0.42 acres  | 0.0008%          |
| (g) Maudie Short Bronson Heirs, Devises, Successors, or Assigns                                  |   |                  |
| (g.1) Kenneth Wingo<br>1509 East Blow Road<br>Signal Mountain, TN 37377                          | 0.0382 acres<br>1/11 of 0.42 acres  | 0.0008%          |
| (h) Effie Shortt Heirs, Devises, Successors, or Assigns  |   |                  |
| (h.1) Garnie Jean Thomas<br>PO Box 745<br>Doran, VA 24612  | 0.0382 acres<br>1/11 of 0.42 acres  | 0.0008%          |
| (i) Gamie Jean Thomson   | <i>Conveyed 11/26/1997 to Harold Shortt and Glenward Shortt as JTWROS, DB 472/104</i> |                  |
| (i.1) Harold B. Shortt   | <i>(DOD 1/6/2017)</i>   |                  |
| (i.2) Glenward Jason Shortt<br>128 And Street<br>Pounding Mill, VA 24637                         | 0.0382 acres<br>1/11 of 0.42 acres  | 0.0008%          |
| (j) Otis Herbert Shortt Heirs, Devises, Successors, or Assigns<br><i>(Documentation Pending)</i> | 0.0382 acres<br>1/11 of 0.42 acres  | 0.0008%          |

Exhibit B3  
VS18  
Docket #VGOB 23-1121-4277-01  
List of all unleased Owners/Claimants  
(4.721.14 Acre Unit)

250000474

|   | Acres in Unit                      | Interest in Unit |
|---|------------------------------------|------------------|
| (k) Raymond B. Short Heirs, Devisees, Successors, or Assigns                          |                                    |                  |
| (k.1) Delcie Norene Short Heirs, Devisees, Successors, or Assigns                     |                                    |                  |
| (k.1.1) Grover Cleveland Elswick<br>5220 Looking Glass Trail<br>Denver, NC 28037      | 0.0191 acres<br>1/22 of 0.42 acres | 0.0004%          |
| (k.1.2) Heather Norene Thornburg<br>1515 Town N Country Drive<br>Wilkesboro, NC 28697 | 0.0191 acres<br>1/22 of 0.42 acres | 0.0004%          |
| OR  |                                    |                  |
| (1) Robert and Jackie Rose<br>1008 Shortts Road<br>Raven, VA 24639                    | 0.42 acres                         | 0.0089%          |
| Total Tract Acres   |                                    | 0.42             |
| Total Tract Percentage  |                                    | 0.0089%          |

**Tract #37A - 0.76 Acres**

\*\*\*Cloud on Title - When Tom Short acquired title to the parent tract of which this property is a portion, he also obtained title to the gas and oil. He then conveyed the property to his wife (Bertha) and reserved all minerals in DB 190/119. Bertha later conveyed back to Tom in DB 217/438, with the same reservation language, though she owned no mineral to reserve. Tom again conveyed to Bertha in DB 281/112, reserving all mineral. Bertha again conveyed to Tom in DB 331/248, and again reserved mineral she did not own. Tom Short and Bertha Short conveyed to Walter M. Short and Jeanette H. Short, in DB 342/400, a 3.2 acre parcel, referencing as the source of title DB 331/248 wherein Bertha reserved mineral she did not own, as the mineral reservation language. The intent of Bertha and Tom Short may have been to reserve all mineral, however, the source reservation language reference within DB 342/400 fails. Correction deeds are necessary to vest title to the oil and gas in either the heirs of Tom Short, or the current surface owners, Robert and Jackie Rose.

|  |                                    |         |
|--|------------------------------------|---------|
| (1) Walter Shortt, et al   | 0.76 acres                         | 0.0161% |
| (a) Tommy Arnold Shortt<br>PO Box 1228<br>Richlands, VA 24641            | 0.0691 acres<br>1/11 of 0.76 acres | 0.0015% |
| (b) Walter Mervin Shortt Heirs, Devisees, Successors, or Assigns         |                                    |         |
| (b.1) Mervin Shortt<br>815 W Thornwood Drive<br>South Elgin, IL 60177    | 0.0230 acres<br>1/33 of 0.76 acres | 0.0005% |
| (b.2) Linda F. Grasso<br>4016 Silk Oak Lane<br>Palm Harbor, FL 34685     | 0.0230 acres<br>1/33 of 0.76 acres | 0.0005% |
| (b.3) Larry Walter Short   | <i>pre-deceased</i>                |         |
| (b.3.1) Larry Short, Jr.<br>436 Waverly Street<br>Kingstord, MI 49802    | 0.0115 acres<br>1/66 of 0.76 acres | 0.0002% |
| (b.3.2) Tamara Beth Ham<br>108 Chesterfield Drive<br>Pinehurst, NC 28374 | 0.0115 acres<br>1/66 of 0.76 acres | 0.0002% |
| (c) Harold B. Shortt Heirs, Devisees, Successors, or Assigns             |                                    |         |

Exhibit B3  
VS18  
Docket #VGOB 23-1121-4277-01  
List of all unleased Owners/Claimants  
(4.721.14 Acre Unit)

|   | Acres in Unit                      | Interest in Unit |
|---|------------------------------------|------------------|
| (c.1) Charlene Shortt<br>PO Box 1818<br>Cedar Bluff, VA 24609   | 0.0691 acres<br>1/11 of 0.76 acres | 0.0015%          |
| (d) Glenward Jason Shortt<br>128 And Street<br>Pounding Mill, VA 24637                                      | 0.0691 acres<br>1/11 of 0.76 acres | 0.0015%          |
| (e) Ballard Charlie Shortt Heirs, Deivsees,<br>Successors, or Assigns                                       |                                    |                  |
| (h.1) Earlean Shortt Heirs, Deivsees,<br>Successors, or Assigns<br><i>(Documentation Pending)</i>           | 0.0691 acres<br>1/11 of 0.76 acres | 0.0015%          |
| (h.1.1) Becky Harris<br>105 Windlass Court<br>Moneta, VA 24121  |                                    |                  |
| (f) Dorothy Short Keene<br>279 Townview Drive<br>Lebanon, VA 24266  | 0.0691 acres<br>1/11 of 0.76 acres | 0.0015%          |
| (g) Maudie Short Bronson Heirs, Deivsees,<br>Successors, or Assigns   |                                    |                  |
| (g.1) Kenneth Wingo<br>1509 East Blow Road<br>Signal Mountain, TN 37377                                     | 0.0691 acres<br>1/11 of 0.76 acres | 0.0015%          |
| (h) Effie Shortt Heirs, Deivsees,<br>Successors, or Assigns   |                                    |                  |
| (h.1) Garnie Jean Thomas<br>PO Box 745<br>Doran, VA 24612   | 0.0691 acres<br>1/11 of 0.76 acres | 0.0015%          |
| (i) Garnie Jean Thomson <i>Conveyed 11/26/1997 to Harold Short and Glenward Short as JTWR0S, DB 472/104</i> |                                    |                  |
| (i.1) Harold B. Shortt <i>(DOD 1/6/2017)</i>  |                                    |                  |
| (i.2) Glenward Jason Short<br>128 And Street<br>Pounding Mill, VA 24637                                     | 0.0691 acres<br>1/11 of 0.76 acres | 0.0015%          |
| (j) Otis Herbert Shortt Heirs, Deivsees,<br>Successors, or Assigns<br><i>(Documentation Pending)</i>        | 0.0691 acres<br>1/11 of 0.76 acres | 0.0015%          |
| (k) Raymond B. Short Heirs, Deivsees,<br>Successors, or Assigns   |                                    |                  |
| (k.1) Delcie Norene Short Heirs, Deivsees,<br>Successors, or Assigns  |                                    |                  |
| (k.1.1) Grover Cleveland Elswick<br>5220 Looking Glass Trail<br>Denver, NC 28037                            | 0.0345 acres<br>1/22 of 0.76 acres | 0.0007%          |
| (k.1.2) Heather Norene Thornburg<br>1515 Town N Country Drive<br>Wilkesboro, NC 28697                       | 0.0345 acres<br>1/22 of 0.76 acres | 0.0007%          |

OR

260000391

250000474

Exhibit B3  
VS18  
Docket #VGOB 23-1121-4277-01  
List of all unleased Owners/Claimants  
(4,721.14 Acre Unit)

|   | Acres in Unit                      | Interest in Unit |
|---|------------------------------------|------------------|
| (1) Robert and Jackie Rose<br>1008 Shortts Road<br>Raven, VA 24639                                | 0.76 acres                         | 0.0161%          |
| Total Tract Acres   | 0.76                               |                  |
| Total Tract Percentage  | 0.0161%                            |                  |
| <b><u>Tract #37B - 8.89 Acres</u></b>   |                                    |                  |
| (1) Walter Shortt, et al  | 8.89 acres                         | 0.1883%          |
| (a) Tommy Arnold Shortt<br>PO Box 1228<br>Richlands, VA 24641                                     | 0.8082 acres<br>1/11 of 8.89 acres | 0.0171%          |
| (b) Walter Mervin Shortt Heirs, Devisees,<br>Successors, or Assigns                               |                                    |                  |
| (b.1) Mervin Shortt<br>815 W Thornwood Drive<br>South Elgin, IL 60177                             | 0.2694 acres<br>1/33 of 8.89 acres | 0.0057%          |
| (b.2) Linda F. Grasso<br>4016 Silk Oak Lane<br>Palm Harbor, FL 34685                              | 0.2694 acres<br>1/33 of 8.89 acres | 0.0057%          |
| (b.3) Larry Walter Short  | <i>pre-deceased</i>                |                  |
| (b.3.1) Larry Short, Jr.<br>436 Waverly Street<br>Kingsford, MI 49802                             | 0.1347 acres<br>1/66 of 8.89 acres | 0.0029%          |
| (b.3.2) Tamara Beth Ham<br>108 Chesterfield Drive<br>Pinehurst, NC 28374                          | 0.1347 acres<br>1/66 of 8.89 acres | 0.0029%          |
| (c) Harold B. Shortt Heirs, Devisees,<br>Successors, or Assigns                                   |                                    |                  |
| (c.1) Charlene Shortt<br>PO Box 1818<br>Cedar Bluff, VA 24609                                     | 0.8082 acres<br>1/11 of 8.89 acres | 0.0171%          |
| (d) Glenward Jason Shortt<br>128 And Street<br>Pounding Mill, VA 24637                            | 0.8082 acres<br>1/11 of 8.89 acres | 0.0171%          |
| (e) Ballard Charlie Shortt Heirs, Devisees,<br>Successors, or Assigns                             |                                    |                  |
| (h.1) Earlean Shortt Heirs, Devisees,<br>Successors, or Assigns<br><i>(Documentation Pending)</i> | 0.8082 acres<br>1/11 of 8.89 acres | 0.0171%          |
| (h.1.1) Becky Harris<br>105 Windlass Court<br>Moneta, VA 24121                                    |                                    |                  |
| (f) Dorothy Short Keene<br>279 Townview Drive<br>Lebanon, VA 24266                                | 0.8082 acres<br>1/11 of 8.89 acres | 0.0171%          |
| (g) Maudie Short Bronson Heirs, Devisees,<br>Successors, or Assigns                               |                                    |                  |

260000391

250000474

Exhibit B3  
 VS18  
 Docket #VGOB 23-1121-4277-01  
 List of all unleased Owners/Claimants  
 (4,721.14 Acre Unit)

|   | Acres in Unit  | Interest in Unit |
|---|--|------------------|
| (g.1) Kenneth Wingo<br>1509 East Blow Road<br>Signal Mountain, TN 37377                               | 0.8082 acres<br>1/11 of 8.89 acres   | 0.0171%          |
| (h) Effie Shortt Heirs, Devisees,<br>Successors, or Assigns   |  |                  |
| (h.1) Garnie Jean Thomas<br>PO Box 745<br>Doran, VA 24612   | 0.8082 acres<br>1/11 of 8.89 acres   | 0.0171%          |
| (i) Garnie Jean Thomson   | <i>Conveyed 11/26/1997 to Harold Shortt and Glenward Shortt as JTWRROS, DB 472/104</i> |                  |
| (i.1) Harold B. Shortt  | <i>(DOD 1/6/2017)</i>  |                  |
| (i.2) Glenward Jason Short<br>128 And Street<br>Pounding Mill, VA 24637                               | 0.8082 acres<br>1/11 of 8.89 acres   | 0.0171%          |
| (j) Otis Herbert Shortt Heirs, Devisees,<br>Successors, or Assigns<br><i>(Documentation Pending)</i>  | 0.8082 acres<br>1/11 of 8.89 acres   | 0.0171%          |
| (k) Raymond B. Short Heirs, Devisees,<br>Successors, or Assigns                                       |  |                  |
| (k.1) Delcie Norene Short Heirs, Devisees,<br>Successors, or Assigns                                  |  |                  |
| (k.1.1) Grover Cleveland Elswick<br>5220 Looking Glass Trail<br>Denver, NC 28037                      | 0.4041 acres<br>1/22 of 8.89 acres   | 0.0086%          |
| (k.1.2) Heather Norene Thornburg<br>1515 Town N Country Drive<br>Wilkesboro, NC 28697                 | 0.4041 acres<br>1/22 of 8.89 acres   | 0.0086%          |
|   | Total Tract Acres  | 8.89             |
|   | Total Tract Percentage   | 0.1883%          |
| <b><u>Tract #37C - 1.01 Acres</u></b>   |  |                  |
| (1) Commonwealth of Virginia<br>Department of Transportation<br>2111 Bonham Road<br>Bristol, VA 24201 | 1.01 acres   | 0.0214%          |
| <b><u>Tract #37D - 0.20 Acres</u></b>   |  |                  |
| (1) Walter Shortt, et al  | 0.20 acres   | 0.0042%          |
| (a) Tommy Arnold Shortt<br>PO Box 1228<br>Richlands, VA 24641   | 0.0182 acres<br>1/11 of 0.20 acres   | 0.0004%          |
| (b) Walter Mervin Shortt Heirs, Devisees,<br>Successors, or Assigns                                   |  |                  |
| (b.1) Mervin Shortt<br>815 W Thornwood Drive<br>South Elgin, IL 60177                                 | 0.0061 acres<br>1/33 of 0.20 acres   | 0.0001%          |

260000391

250000474

Exhibit B3  
VS18  
Docket #VGOB 23-1121-4277-01  
List of all unleased Owners/Claimants  
(4,721.14 Acre Unit)

|   | Acres in Unit   | Interest in Unit |
|---|---|------------------|
| (b.2) Linda F. Grasso<br>4016 Silk Oak Lane<br>Palm Harbor, FL 34685                                | 0.0061 acres<br>1/33 of 0.20 acres  | 0.0001%          |
| (b.3) Larry Walter Short  | <i>pre-deceased</i>   |                  |
| (b.3.1) Larry Short, Jr.<br>436 Waverly Street<br>Kingsford, MI 49802                               | 0.0030 acres<br>1/66 of 0.20 acres  | 0.0001%          |
| (b.3.2) Tamara Beth Ham<br>108 Chesterfield Drive<br>Pinehurst, NC 28374                            | 0.0030 acres<br>1/66 of 0.20 acres  | 0.0001%          |
| (c) Harold B. Shortt Heirs, Devises,<br>Successors, or Assigns                                      |   |                  |
| (c.1) Charlene Shortt<br>PO Box 1818<br>Cedar Bluff, VA 24609                                       | 0.0182 acres<br>1/11 of 0.20 acres  | 0.0004%          |
| (d) Glenward Jason Shortt<br>128 And Street<br>Pounding Mill, VA 24637                              | 0.0182 acres<br>1/11 of 0.20 acres  | 0.0004%          |
| (e) Ballard Charlie Shortt Heirs, Deivsees,<br>Successors, or Assigns                               |   |                  |
| (h.1) Earlean Shortt Heirs, Devises,<br>Successors, or Assigns<br><i>(Documentation Pending)</i>    | 0.0182 acres<br>1/11 of 0.20 acres  | 0.0004%          |
| (h.1.1) Becky Harris<br>105 Windlass Court<br>Moneta, VA 24121                                      |   |                  |
| (f) Dorothy Short Keene<br>279 Townview Drive<br>Lebanon, VA 24266                                  | 0.0182 acres<br>1/11 of 0.20 acres  | 0.0004%          |
| (g) Maudie Short Bronson Heirs, Devises,<br>Successors, or Assigns                                  |   |                  |
| (g.1) Kenneth Wingo<br>1509 East Blow Road<br>Signal Mountain, TN 37377                             | 0.0182 acres<br>1/11 of 0.20 acres  | 0.0004%          |
| (h) Effie Shortt Heirs, Devises,<br>Successors, or Assigns  |   |                  |
| (h.1) Garnie Jean Thomas<br>PO Box 745<br>Doran, VA 24612   | 0.0182 acres<br>1/11 of 0.20 acres  | 0.0004%          |
| (i) Garnie Jean Thomson   | <i>Conveyed 11/26/1997 to Harold Short and Glenward Short as JTWROS, DB 472/104</i> |                  |
| (i.1) Harold B. Shortt  | <i>(DOD 1/6/2017)</i>   |                  |
| (i.2) Glenward Jason Short<br>128 And Street<br>Pounding Mill, VA 24637                             | 0.0182 acres<br>1/11 of 0.20 acres  | 0.0004%          |
| (j) Otis Herbert Shortt Heirs, Devises,<br>Successors, or Assigns<br><i>(Documentation Pending)</i> | 0.0182 acres<br>1/11 of 0.20 acres  | 0.0004%          |

260000391

250000474

Exhibit B3  
VS18  
Docket #VGOB 23-1121-4277-01  
List of all unleased Owners/Claimants  
(4.721.14 Acre Unit)

|  | Acres in Unit                      | Interest in Unit |
|--|------------------------------------|------------------|
| (k) Raymond B. Short Heirs, Devisees, Successors, or Assigns                                   |                                    |                  |
| (k.1) Dalcie Norene Short Heirs, Devisees, Successors, or Assigns                              |                                    |                  |
| (k.1.1) Grover Cleveland Eiswick<br>5220 Looking Glass Trail<br>Denver, NC 28037               | 0.0091 acres<br>1/22 of 0.20 acres | 0.0002%          |
| (k.1.2) Heather Norene Thornburg<br>1515 Town N Country Drive<br>Wilkesboro, NC 28697          | 0.0091 acres<br>1/22 of 0.20 acres | 0.0002%          |
| Total Tract Acres  | 0.20                               |                  |
| Total Tract Percentage   | 0.0042%                            |                  |
| <b>Tract #37E - 0.04 Acres</b>   |                                    |                  |
| (1) Walter Shortt, et al   | 0.04 acres                         | 0.0008%          |
| (a) Tommy Arnold Shortt<br>PO Box 1228<br>Richlands, VA 24641                                  | 0.0036 acres<br>1/11 of 0.04 acres | 0.0001%          |
| (b) Walter Mervin Shortt Heirs, Devisees, Successors, or Assigns                               |                                    |                  |
| (b.1) Mervin Shortt<br>815 W Thornwood Drive<br>South Elgin, IL 60177                          | 0.0012 acres<br>1/33 of 0.04 acres | 0.0000%          |
| (b.2) Linda F. Grasso<br>4016 Silk Oak Lane<br>Palm Harbor, FL 34685                           | 0.0012 acres<br>1/33 of 0.04 acres | 0.0000%          |
| (b.3) Larry Walter Shortt  | <i>pre-deceased</i>                |                  |
| (b.3.1) Larry Shortt, Jr.<br>436 Waverly Street<br>Kingsford, MI 49802                         | 0.0006 acres<br>1/66 of 0.04 acres | 0.0000%          |
| (b.3.2) Tamara Beth Ham<br>108 Chesterfield Drive<br>Pinehurst, NC 28374                       | 0.0006 acres<br>1/66 of 0.04 acres | 0.0000%          |
| (c) Harold B. Shortt Heirs, Devisees, Successors, or Assigns                                   |                                    |                  |
| (c.1) Charlene Shortt<br>PO Box 1818<br>Cedar Bluff, VA 24609                                  | 0.0036 acres<br>1/11 of 0.04 acres | 0.0001%          |
| (d) Glenward Jason Shortt<br>128 And Street<br>Pounding Mill, VA 24637                         | 0.0036 acres<br>1/11 of 0.04 acres | 0.0001%          |
| (e) Ballard Charlie Shortt Heirs, Devisees, Successors, or Assigns                             |                                    |                  |
| (h.1) Earlean Shortt Heirs, Devisees, Successors, or Assigns<br><i>(Documentation Pending)</i> | 0.0036 acres<br>1/11 of 0.04 acres | 0.0001%          |

260000391

Exhibit B3  
 VS18  
 Docket #VGOB 23-1121-4277-01  
 List of all unleased Owners/Claimants  
 (4.721.14 Acre Unit)

250000474

|  | Acres in Unit   | Interest in Unit |
|--|---|------------------|
| (h.1.1) Becky Harris<br>105 Windlass Court<br>Moneta, VA 24121                                       |   |                  |
| (f) Dorothy Short Keene<br>279 Townview Drive<br>Lebanon, VA 24266                                   | 0.0036 acres<br>1/11 of 0.04 acres  | 0.0001%          |
| (g) Maudie Short Bronson Heirs, Devisees,<br>Successors, or Assigns                                  |   |                  |
| (g.1) Kenneth Wingo<br>1509 East Blow Road<br>Signal Mountain, TN 37377                              | 0.0036 acres<br>1/11 of 0.04 acres  | 0.0001%          |
| (h) Effie Shortt Heirs, Devisees,<br>Successors, or Assigns  |   |                  |
| (h.1) Garnie Jean Thomas<br>PO Box 745<br>Doran, VA 24612  | 0.0036 acres<br>1/11 of 0.04 acres  | 0.0001%          |
| (i) Garnie Jean Thomson  | <i>Conveyed 11/26/1997 to Harold Short and Glenward Short as JTWRDS, DB 472/104</i> |                  |
| (i.1) Harold B. Shortt   | <i>(DOD 1/6/2017)</i>   |                  |
| (i.2) Glenward Jason Short<br>128 And Street<br>Pounding Mill, VA 24637                              | 0.0036 acres<br>1/11 of 0.04 acres  | 0.0001%          |
| (j) Otis Herbert Shortt Heirs, Devisees,<br>Successors, or Assigns<br><i>(Documentation Pending)</i> | 0.0036 acres<br>1/11 of 0.04 acres  | 0.0001%          |
| (k) Raymond B. Short Heirs, Devisees,<br>Successors, or Assigns                                      |   |                  |
| (k.1) Delcie Norene Short Heirs, Devisees,<br>Successors, or Assigns                                 |   |                  |
| (k.1.1) Grover Cleveland Elswick<br>5220 Looking Glass Trail<br>Denver, NC 28037                     | 0.0018 acres<br>1/22 of 0.04 acres  | 0.0000%          |
| (k.1.2) Heather Norene Thornburg<br>1515 Town N Country Drive<br>Wilkesboro, NC 28697                | 0.0018 acres<br>1/22 of 0.04 acres  | 0.0000%          |
| Total Tract Acres  | 0.04  |                  |
| Total Tract Percentage   | 0.0008%   |                  |

**Tract #41B - 23.97 Acres**

|  |                                    |         |
|--|------------------------------------|---------|
| (1) Curtis Elster Wade Heirs   | 23.97 acres                        | 0.5077% |
| (a) Laura B. Wade Heirs, Devisees,<br>Successors, or Assigns         |                                    |         |
| (a.1) Curtis R. Wade<br>926 High Point Drive<br>Mount Dora, FL 32757 | 3.4243 acres<br>1/7 of 23.97 acres | 0.0725% |
| (a.2) Barbara W. Hendrix<br>127 W Meldody Drive<br>Jesup, GA 31545   | 3.4243 acres<br>1/7 of 23.97 acres | 0.0725% |

260000391

250000474

Exhibit B3  
VS18  
Docket #VGOB 23-1121-4277-01  
List of all unleased Owners/Claimants  
(4,721.14 Acre Unit)

|   | Acres in Unit                      | Interest in Unit |
|---|------------------------------------|------------------|
| (a.3) Susan J. Wade<br>6745 N Richmond Street<br>Chicago, IL 60645        | 3.4243 acres<br>1/7 of 23.97 acres | 0.0725%          |
| (a.4) Lydia R. Freund<br>734 Norton Avenue<br>Mundelein, IL 60060         | 3.4243 acres<br>1/7 of 23.97 acres | 0.0725%          |
| (a.5) Thelma Josie Wade<br>16330 Old Timber Road<br>Abingdon, VA 24210    | 3.4243 acres<br>1/7 of 23.97 acres | 0.0725%          |
| (a.6) Julia W. Beckham<br>12500 Virtudes Street<br>Coral Gables, FL 33156 | 3.4243 acres<br>1/7 of 23.97 acres | 0.0725%          |
| (a.7) Nathan Wade<br>113 Hillrose Avenue<br>Greenville, SC 29609          | 3.4243 acres<br>1/7 of 23.97 acres | 0.0725%          |
| Total Tract Acres   | 23.97                              |                  |
| Total Tract Percentage  | 0.5077%                            |                  |
| <b><u>Tract #41C - 10.72 Acres</u></b>                                    |                                    |                  |
| (1) Gerald K. Shortt<br>1475 Shortts Road<br>Raven, VA 24639              | 10.72 acres                        | 0.2271%          |
| <b><u>Tract #41D - 3.41 Acres</u></b>                                     |                                    |                  |
| (1) Rondal & Freda Wade, TE<br>1053 Short Hill Road<br>Raven, VA 24639    | 3.41 acres                         | 0.0722%          |
| <b><u>Tract #41E - 1.72 Acres</u></b>                                     |                                    |                  |
| (1) Jimmy & Linda Wade, TE<br>1333 Short Hill Road<br>Raven, VA 24639     | 1.72 acres                         | 0.0364%          |
| <b><u>Tract #41F - 1.66 Acres</u></b>                                     |                                    |                  |
| (1) Evelyn Sprinkle Brown Heirs, Devisees,<br>Successors, or Assigns      | 1.66 acres                         | 0.0352%          |
| (a) Dianne Creed<br>18593 Ironwood Loop<br>Abingdon, VA 24210             | 0.5533 acres<br>1/3 of 1.66 acres  | 0.0117%          |
| (b) William Richard Brown<br>1907 Riverside Drive<br>Raven, VA 24639      | 0.5533 acres<br>1/3 of 1.66 acres  | 0.0117%          |
| (c) Dorothy Wallace<br>410 First Street<br>Spencer, NC 28159              | 0.5533 acres<br>1/3 of 1.66 acres  | 0.0117%          |
| Total Tract Acres   | 1.66                               |                  |
| Total Tract Percentage  | 0.0352%                            |                  |

260000391

250000474

Exhibit B3  
VS18  
Docket #VGOB 23-1121-4277-01  
List of all unleased Owners/Claimants  
(4,721.14 Acre Unit)

|   | Acres in Unit    | Interest in Unit |
|---|------------------|------------------|
| <b><u>Tract #41G - 0.25 Acres</u></b>   |                  |                  |
| (1) Commonwealth of Virginia<br>Department of Transportation<br>2111 Bonham Road<br>Bristol, VA 24201 | 0.25 acres       | 0.0053%          |
| <b><u>Tract #41H - 1.45 Acres</u></b>   |                  |                  |
| (1) Eimer & Elsie Burke, TE<br>1759 Riverside Dr<br>Raven, VA 24639                                   | 1.45 acres       | 0.0307%          |
| <b><u>TOTAL UNLEASED OIL AND GAS ESTATE</u></b>   |                  |                  |
|   | Total Acres      | 136.92           |
|   | Total Percentage | 2.9001%          |

260000391  
250000474

Exhibit E  
VS18  
Docket #VGOB 23-1121-4277-01  
List of Conflicting Owners/Claimants requiring Escrow  
(4.721.14 Acre Unit)

|  | Acres in Unit                      | Interest in Unit |
|--|------------------------------------|------------------|
| <b>ii. OIL &amp; GAS OWNERSHIP</b>   |                                    |                  |
| <b><u>Tract #36C - 0.42 Acres</u></b>  |                                    |                  |
| <i>***Cloud on Title - When Tom Shortt acquired title to the parent tract of which this property is a portion, he also obtained title to the gas and oil. He then conveyed the property to his wife (Bertha) and reserved all minerals in DB 190/119. Bertha later conveyed back to Tom in DB 217/438, with the same reservation language, though she owned no mineral to reserve. Tom again conveyed to Bertha in DB 281/12, reserving all mineral. Bertha again conveyed to Tom in DB 331/248, and again reserved mineral she did not own. Tom Shortt and Bertha Shortt conveyed to Walter M. Shortt and Jeanette H. Shortt, in DB 342/400, a 3.2 acre parcel, referencing as the source of title DB 331/248 wherein Bertha reserved mineral she did not own, as the mineral reservation language. The intent of Bertha and Tom Shortt may have been to reserve all mineral, however, the source reservation language reference within DB 342/400 fails. Correction deeds are necessary to vest title to the oil and gas in either the heirs of Tom Shortt, or the current surface owners: Robert and Jackie Rose.</i> |                                    |                  |
| (1) Walter Shortt, et al   | 0.42 acres                         | 0.0089%          |
| (a) Tommy Arnold Shortt<br>PO Box 1228<br>Richlands, VA 24641  | 0.0382 acres<br>1/11 of 0.42 acres | 0.0008%          |
| (b) Walter Mervin Shortt Heirs, Devisees,<br>Successors, or Assigns  |                                    |                  |
| (b.1) Mervin Shortt<br>815 W Thornwood Drive<br>South Elgin, IL 60177  | 0.0127 acres<br>1/33 of 0.42 acres | 0.0003%          |
| (b.2) Linda F. Grasso<br>4016 Silk Oak Lane<br>Palm Harbor, FL 34685   | 0.0127 acres<br>1/33 of 0.42 acres | 0.0003%          |
| (b.3) Larry Walter Shortt  | <i>pre-deceased</i>                |                  |
| (b.3.1) Larry Shortt, Jr.<br>436 Waverly Street<br>Kingsford, MI 49802   | 0.0064 acres<br>1/66 of 0.42 acres | 0.0001%          |
| (b.3.2) Tamara Beth Ham<br>108 Chesterfield Drive<br>Pinehurst, NC 28374   | 0.0064 acres<br>1/66 of 0.42 acres | 0.0001%          |
| (c) Harold B. Shortt Heirs, Devisees,<br>Successors, or Assigns  |                                    |                  |
| (c.1) Charlene Shortt<br>PO Box 1818<br>Cedar Bluff, VA 24609  | 0.0382 acres<br>1/11 of 0.42 acres | 0.0008%          |
| (d) Glenward Jason Shortt<br>128 And Street<br>Pounding Mill, VA 24637   | 0.0382 acres<br>1/11 of 0.42 acres | 0.0008%          |
| (e) Ballard Charlie Shortt Heirs, Devisees,<br>Successors, or Assigns  |                                    |                  |
| (h.1) Earlean Shortt Heirs, Devisees,<br>Successors, or Assigns<br><i>(Documentation Pending)</i>  | 0.0382 acres<br>1/11 of 0.42 acres | 0.0008%          |
| (h.1.1) Becky Harris<br>105 Windlass Court<br>Moneta, VA 24121   |                                    |                  |
| (f) Dorothy Short Keene<br>279 Townview Drive<br>Lebanon, VA 24266   | 0.0382 acres<br>1/11 of 0.42 acres | 0.0008%          |
| (g) Maudie Short Bronson Heirs, Devisees,<br>Successors, or Assigns  |                                    |                  |
| (g.1) Kenneth Wingo<br>1509 East Blow Road<br>Signal Mountain, TN 37377  | 0.0382 acres<br>1/11 of 0.42 acres | 0.0008%          |
| (h) Effie Shortt Heirs, Devisees,<br>Successors, or Assigns  |                                    |                  |
| (h.1) Garnie Jean Thomas<br>PO Box 745<br>Doran, VA 24612  | 0.0382 acres<br>1/11 of 0.42 acres | 0.0008%          |

260000391  
250000474

Exhibit E  
VS18  
Docket #VGOB 23-1121-4277-01  
List of Conflicting Owners/Claimants requiring Escrow  
(4,721.14 Acre Unit)

|   | Acres in Unit                      | Interest in Unit |
|---|------------------------------------|------------------|
| (i) Garnie Jean Thomson <i>Conveyed 11/26/1967 to Harold Short and Glenward Short as JTWRGS, DB 472/104</i> |                                    |                  |
| (i.1) Harold B. Short <i>(DOD 1/6/2017)</i>   |                                    |                  |
| (i.2) Glenward Jason Short<br>128 And Street<br>Pounding Mill, VA 24637                                     | 0.0382 acres<br>1/11 of 0.42 acres | 0.0008%          |
| (j) Otis Herbert Shortt Heirs, Devises,<br>Successors, or Assigns<br><i>(Documentation Pending)</i>         | 0.0382 acres<br>1/11 of 0.42 acres | 0.0008%          |
| (k) Raymond B. Short Heirs, Devises,<br>Successors, or Assigns  |                                    |                  |
| (k.1) Delcie Norene Short Heirs, Devises,<br>Successors, or Assigns   |                                    |                  |
| (k.1.1) Grover Cleveland Elswick<br>5220 Locking Glass Trail<br>Denver, NC 28037                            | 0.0191 acres<br>1/22 of 0.42 acres | 0.0004%          |
| (k.1.2) Heather Norene Thornburg<br>1515 Town N Country Drive<br>Wikesboro, NC 28697                        | 0.0191 acres<br>1/22 of 0.42 acres | 0.0004%          |
| OR  |                                    |                  |
| (l) Robert and Jackie Rose<br>1008 Shortts Road<br>Raven, VA 24639  | 0.42 acres                         | 0.0086%          |

**Tract #37A - 0.76 Acres**

\*\*\*Cloud on Title - When Tom Short acquired title to the parent tract of which this property is a portion, he also obtained title to the gas and oil. He then conveyed the property to his wife (Bertha) and reserved all minerals in DB 190/119. Bertha later conveyed back to Tom in DB 217/438 with the same reservation language, though she owned no mineral to reserve. Tom again conveyed to Bertha in DB 281/112, reserving all mineral. Bertha again conveyed to Tom in DB 331/248, and again reserved mineral she did not own. Tom Short and Bertha Short conveyed to Walter M. Short and Jeanette H. Short in DB 342/400, a 3.2 acre parcel, referencing as the source of title DB 331/248 wherein Bertha reserved mineral she did not own, as the mineral reservation language. The intent of Bertha and Tom Short may have been to reserve all mineral, however, the source reservation language reference within DB 342/400 fails. Correction deeds are necessary to vest title to the oil and gas in either the heirs of Tom Short, or the current surface owners, Robert and Jackie Rose.

|  |                                    |         |
|--|------------------------------------|---------|
| (1) Walter Shortt, et al   | 0.76 acres                         | 0.0161% |
| (a) Tommy Arnold Shortt<br>PO Box 1228<br>Richlands, VA 24641            | 0.0691 acres<br>1/11 of 0.76 acres | 0.0015% |
| (b) Walter Mervin Shortt Heirs, Devises,<br>Successors, or Assigns       |                                    |         |
| (b.1) Mervin Shortt<br>815 W Thornwood Drive<br>South Elgin, IL 60177    | 0.0230 acres<br>1/33 of 0.76 acres | 0.0005% |
| (b.2) Linda F. Grasso<br>4016 Silk Oak Lane<br>Palm Harbor, FL 34686     | 0.0230 acres<br>1/33 of 0.76 acres | 0.0005% |
| (b.3) Larry Walter Short   | <i>pre-deceased</i>                |         |
| (b.3.1) Larry Short, Jr.<br>436 Waverly Street<br>Kingsford, MI 49802    | 0.0115 acres<br>1/66 of 0.76 acres | 0.0002% |
| (b.3.2) Tamara Beth Ham<br>108 Chesterfield Drive<br>Pinehurst, NC 28374 | 0.0115 acres<br>1/66 of 0.76 acres | 0.0002% |
| (c) Harold B. Shortt Heirs, Devises,<br>Successors, or Assigns           |                                    |         |
| (c.1) Charlene Shortt<br>PO Box 1818<br>Cedar Bluff, VA 24609            | 0.0691 acres<br>1/11 of 0.76 acres | 0.0015% |

260000391

250000474

Exhibit E  
 VS18  
 Docket #VGOB 23-1121-4277-01  
 List of Conflicting Owners/Claimants requiring Escrow  
 (4.721.14 Acre Unit)

|   | Acres in Unit                      | Interest in Unit |
|---|------------------------------------|------------------|
| (d) Glenward Jason Shortt<br>128 And Street<br>Pounding Mill, VA 24637  | 0.0691 acres<br>1/11 of 0.76 acres | 0.0015%          |
| (e) Ballard Charlie Shortt Heirs, Devises,<br>Successors, or Assigns  |                                    |                  |
| (h.1) Earlean Shortt Heirs, Devises,<br>Successors, or Assigns<br><i>(Documentation Pending)</i>              | 0.0691 acres<br>1/11 of 0.76 acres | 0.0015%          |
| (h.1.1) Becky Harris<br>105 Windlass Court<br>Moneta, VA 24121  |                                    |                  |
| (f) Dorothy Short Keene<br>279 Townview Drive<br>Lebanon, VA 24266  | 0.0691 acres<br>1/11 of 0.76 acres | 0.0015%          |
| (g) Maudie Short Bronson Heirs, Devises,<br>Successors, or Assigns  |                                    |                  |
| (g.1) Kenneth Wingo<br>1509 East Blow Road<br>Signal Mountain, TN 37377                                       | 0.0691 acres<br>1/11 of 0.76 acres | 0.0015%          |
| (h) Effie Shortt Heirs, Devises,<br>Successors, or Assigns  |                                    |                  |
| (h.1) Garnie Jean Thomas<br>PO Box 745<br>Doran, VA 24612   | 0.0691 acres<br>1/11 of 0.76 acres | 0.0015%          |
| (i) Garnie Jean Thomson <i>Conveyed 11/26/1997 to Harold Short and Glenward Shortt as JTWRROS. DB 472/104</i> |                                    |                  |
| (i.1) Harold B. Shortt <i>(DOD 1/6/2017)</i>  |                                    |                  |
| (i.2) Glenward Jason Shortt<br>128 And Street<br>Pounding Mill, VA 24637                                      | 0.0691 acres<br>1/11 of 0.76 acres | 0.0015%          |
| (j) Otis Herbert Shortt Heirs, Devises,<br>Successors, or Assigns<br><i>(Documentation Pending)</i>           | 0.0691 acres<br>1/11 of 0.76 acres | 0.0015%          |
| (k) Raymond B. Short Heirs, Devises,<br>Successors, or Assigns  |                                    |                  |
| (k.1) Delcie Norene Short Heirs, Devises,<br>Successors, or Assigns   |                                    |                  |
| (k.1.1) Grover Cleveland Elswick<br>5220 Looking Glass Trail<br>Denver, NC 28037                              | 0.0345 acres<br>1/22 of 0.76 acres | 0.0007%          |
| (k.1.2) Heather Norene Thornburg<br>1515 Town N Country Drive<br>Wilkesboro, NC 28697                         | 0.0345 acres<br>1/22 of 0.76 acres | 0.0007%          |
| OR  |                                    |                  |
| (1) Robert and Jackie Rose<br>1008 Shortts Road<br>Raven, VA 24639  | 0.76 acres                         | 0.0161%          |

Total Acres 1.18  
 Total Percentage 0.0250%

INSTRUMENT 250000474  
 RECORDED IN THE CLERK'S OFFICE OF  
 BUCHANAN COUNTY CIRCUIT COURT ON  
 MAY 6, 2025 AT 02:45 PM  
 BEVERLY S. TILLER, CLERK  
 RECORDED BY: CXE

#76

260000391

260000391

INSTRUMENT 260000391  
RECORDED IN THE CLERK'S OFFICE OF  
BUCHANAN COUNTY CIRCUIT COURT ON  
MARCH 27, 2026 AT 03:16 PM  
BEVERLY S. TILLER, CLERK  
RECORDED BY: LMP

**VIRGINIA LAND RECORD COVER SHEET**

Commonwealth of Virginia VA. CODE §§ 17.1-223, -227.1, -249

**FORM A – COVER SHEET CONTENT**

Instrument Date: 4/21/2025

Instrument Type: ODU

Number of Parcels: 0 Number of Pages: 65

[ ] City [X] County RUSSELL  
CIRCUIT COURT

Tax Exempt? VIRGINIA/FEDERAL CODE SECTION

[X] Grantor: VA GAS AND OIL BOARD

[X] Grantee: POCAHONTAS GAS LLC

Business/Name

1 X Grantor: VIRGINIA GAS AND OIL BOARD

Grantor:

1 X Grantee: POCAHONTAS GAS LLC

2 X Grantee: COAL MOUNTAIN MINING COMPANY LLP

Grantee Address

Name: POCAHONTAS GAS LLC

Address: P O BOX 570

City: POUNDING MILL State: VA Zip Code: 24637

Consideration: \$0.00 Existing Debt: \$0.00 Actual Value/Assumed: \$0.00

PRIOR INSTRUMENT UNDER § 58.1-803(D):

Original Principal: \$0.00 Fair Market Value Increase: \$0.00

Original Book No.: Original Page No.: Original Instrument No.:

Prior Recording At: [ ] City [ ] County Percentage In This Jurisdiction:

Book Number: Page Number: Instrument Number:

Parcel Identification Number/Tax Map Number:

Short Property Description:

Current Property Address:

City: State: Zip Code:

Instrument Prepared By: VA GAS AND OIL BOARD Recording Paid By: VA DEPT OF ENERGY

Recording Returned To: VA DEPARTMENT OF ENERGY

Address: 3405 MOUNTAIN EMPIRE ROAD

City: BIG STONE GAP State: VA Zip Code: 24219

INSTRUMENT 260000742  
RECORDED IN THE CLERK'S OFFICE OF  
RUSSELL CIRCUIT COURT ON  
APRIL 30, 2026 AT 09:20 AM  
KATIE PATTON, CLERK  
RECORDED BY: CMH

(Area Above Reserved For Deed Stamp Only)

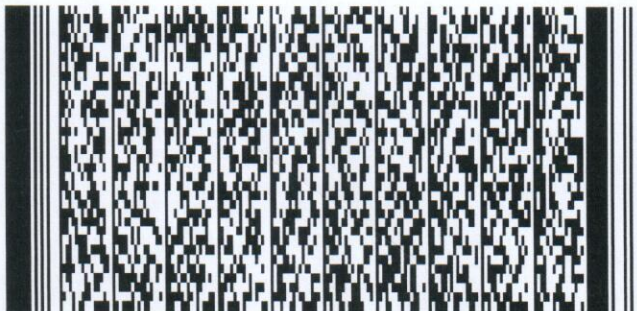

2026-1120

**VIRGINIA LAND RECORD COVER SHEET**

Commonwealth of Virginia VA. CODE §§ 17.1-223, -227.1, -249

**FORM A - COVER SHEET CONTENT**

Instrument Date: 4/21/2025

Instrument Type: ODU

Number of Parcels: 0 Number of Pages: 65

City  County TAZEWELL  
CIRCUIT COURT

Tax Exempt? VIRGINIA/FEDERAL CODE SECTION

Grantor: VA GAS AND OIL BOARD

Grantee: POCAHONTAS GAS LLC

**Business/Name**

1  Grantor: VIRGINIA GAS AND OIL BOARD

Grantor:

1  Grantee: POCAHONTAS GAS LLC

2  Grantee: COAL MOUNTAIN MINING COMPANY LLP

**Grantee Address**

Name: POCAHONTAS GAS LLC

Address: P O BOX 570

City: POUNDING MILL State: VA Zip Code: 24637

Consideration: \$0.00 Existing Debt: \$0.00 Actual Value/Assumed: \$0.00

**PRIOR INSTRUMENT UNDER § 58.1-803(D):**

Original Principal: \$0.00 Fair Market Value Increase: \$0.00

Original Book No.: Original Page No.: Original Instrument No.:

Prior Recording At:  City  County Percentage In This Jurisdiction:

Book Number: Page Number: Instrument Number:

Parcel Identification Number/Tax Map Number:

Short Property Description:

Current Property Address:

City: State: Zip Code:

Instrument Prepared By: VA GAS AND OIL BOARD Recording Paid By: VA DEPT OF ENERGY

Recording Returned To: VA DEPARTMENT OF ENERGY

Address: 3405 MOUNTAIN EMPIRE ROAD

City: BIG STONE GAP State: VA Zip Code: 24219



INSTRUMENT 202601120  
RECORDED IN THE CLERK'S OFFICE OF  
TAZEWELL COUNTY CIRCUIT COURT ON  
MAY 7, 2026 AT 08:46 AM  
CHARITY D. HURST, CLERK  
RECORDED BY: KPG

*Kathy Crouse*

(Area Above Reserved For Deed Stamp Only)